

NETWORK NEWS

March-June 2018
Vol. 36 - No. 1

Quarterly resource publication for single mothers

Call or email to be added to News mailing list: 262-251-7333 info@hopenetworkinc.org

HOPE grants can help with tuition or day care

HOPE Network is offering its Edmund Springman Educational Grants to single mothers pursuing post-high-school education (technical school or college). The money may be used to cover tuition, day-care costs while the mother is in classes, or both. Grants will be given for the fall 2018 & spring 2019 spring semesters.

Applications must be postmarked by April 30.

Applicants must be HOPE Network members, and can submit membership applications (see form on website) when applying for the grant. Grant winners will volunteer 10 hours to HOPE Network or a local community organization. You may print out the application form from our website. Submit to HOPE with 3 photocopies of everything, as specified on the form. Our website is: www.hopenetworkinc.org

We need your help!

We'd like to award seven scholarships of at least \$1,000 but we need your help! Please see back cover to donate.

City of Milwaukee Health Department

Lead Information

HOTLINE

414-286-8800

LeadSafeMKE.com SAFE PAINT SAFE WATER SAFE KIDS Lead-Safe Milwaukee

The Milwaukee Health Department has a hotline to provide parents and others with information about lead risks. Staff will answer questions, let you know how you can get a water filter, and where you can go to have your child tested for lead. The hotline is open 8am-4:45pm M-F. Information is also available at www.milwaukee.gov/health. Follow the Health Dept. on Twitter: @MKEhealth and Facebook to stay up-to-date on lead and other public health information.

Lead hotline: 414-286-8800

Exposure to lead is especially harmful to children under the age of 6 because their bodies absorb more lead than adults, and their brains and nervous systems are more sensitive to the damaging effects of lead. Pregnant and breastfeeding women, or women of childbearing ages (15-45 years), should be aware of lead hazards in order to prevent exposure to a developing baby.



We're all looking forward to spring, and the baseball season! A HOPE Network mother enjoys a game at Miller Park last year with her children, thanks to free tickets to HOPE from the Brewers Buddies

Enjoy roller derby March 17 and earn money for HOPE Network! 7pm UW-Milwaukee Panther Arena. As their featured charity, we'll receive a donation from proceeds. 400 W. Kilbourn



Create a lead-safe home

6-8pm March 21 workshop, Wisconsin Black Historical Society, 2620 W. Center St. Learn how to identify and address lead in paint, water and soil. FREE water filters and lead tests for eligible families. Education about the impact of lead from a health professional.

Renovate to be lead-safe; free starter kit

6-8pm April 4 workshop, Journey House, 2110 W. Scott St. Learn lead-safe practices while renovating your property. Learn how to identify lead in the home, with demonstrations on how to control unsafe areas, until you can renovate. Bring your questions. Take home a free renovation starter kit with duct tape, plastic sheeting, bags, and more.

Both workshops sponsored by Sixteenth Street Community Health Center. Info: Carmen, 897-5592.

Enjoy a cocktail, and earn money for HOPE!



Each month, Story Hill BKC toasts a local community organization with a cocktail. In May and June, \$1 from every tapped sangria purchased will go to HOPE Network. Story Hill is part of the acclaimed restaurant group that includes Blue's Egg and Maxie's. A recent *Milwaukee Magazine* review picked two of their cocktails among the 18 best in the city. 5100 W. Bluemound Rd. 539-4424

HOPE NETWORK NEWS

Quarterly community resource publication
by HOPE Network for Single Mothers

Phone: 262-251-7333 **Fax:** 262-251-2088

General inquiries info@hopenetworkinc.org

Membership & business admin@hopenetworkinc.org

Website: www.hopenetworkinc.org

Mailing address: PO Box 531, Menomonee Falls, WI 53052

Office location: Room #201, Good Shepherd Church,
N88 W17658 Christman Rd., Menomonee Falls, 53051

Office hours: call first, as our hours vary during the transition

Staff: Pauline Beck and Gail Grenier Sweet
Pauline Beck, News Editor

Editorial Researchers: Karen Hebert, Brad Klages, Emily Perkins, Ben Pliske, Brad Sagadin, Barb Schmit, M. Schultz, Pat Wille

Columnists: Gail Grenier Sweet and Pam Oberg-Sutton

Board of Directors

Pauline Beck, director	Pamela Oberg-Sutton, director
Kanasha Durr, director	Leah Pounds, director
Nadiyah Groves, director	Sarah Rigel, treasurer
Crystal Hearvey, vice president	Krista LaFave Rosolino, secretary
Lisa Lopacinski, president	Gail Grenier Sweet, director
Andrew Meyer, director	

See information on HOPE Network's services on back page.

Mobile Legal Clinic

One-time consultation with an attorney offering free, brief legal advice on most civil matters. Includes family law, landlord-tenant issues, small claims, large claims, and credit-consumer issues. Cannot do criminal cases or provide ongoing help. Cannot provide ongoing representation, but can offer info on how to retain an attorney if needed. Clinic stops taking walk-ins when sign-up list is full. Run by Marquette & Milw. Bar Assn.

Mar. 29 8:30-10:30am St. John's West, 5500 W. Greenfield.
Apr. 7 9-11am Dominican Center for Women, 2470 W Locust
Apr. 13 2-4pm Milw. Rescue Mission-Marquette, 830 N 19
Apr. 14 9-11am Riverwest Food Pantry, 924 E Clarke St
Apr. 14 noon-2pm City on a Hill, 2224 W. Kilbourn Ave.
Apr. 21 10am-noon Hope House, 209 W Orchard St
Apr. 26 8:30-10:30am St. John's West, 5500 W. Greenfield Ave.
May 1 9:30-11:30am Washington Park Sr Center, 4420 W. Vliet
May 11 2-4pm Milw. Rescue Mission-Marquette, 830 N 19
May 12 9-11am Riverwest Food Pantry, 924 E Clarke
May 12 noon-2pm City on a Hill, 2224 W. Kilbourn Ave.
May 19 10am-noon, Despensa de la Paz, 1615 S. 22
May 31 8:30-10:30am St. John's West, 5500 W. Greenfield
June 5 9:30-11:30am Washington Park Sr Center, 4420 W. Vliet
June 8 2-4pm Milw. Rescue Mission-Marquette, 830 N 19
June 9 9-11am Riverwest Food Pantry, 924 E Clarke St
June 9 noon-2pm City on a Hill, 2224 W. Kilbourn Ave.
June 16 10am-noon Hope House, 209 W Orchard St

Problems with public benefits?

Legal Action of Wis: free legal assistance for W-2, food stamps, medical assistance, childcare, or other public benefit problems. Also: family law, landlord/tenant, school problems. Call 278-7722, 888-278-0633 for times/location. Other help: Repairers of the Breach, 934-9305; Welfare Warriors Helpline: 342-6662

Table of Contents

Pages 2-3 HOPE Network office information, emergency help, legal resources.
Pages 4-5 Nutrition, fitness, columnist
Page 6-7 Waukesha County resources and events
Pages 7-8 Wellness news, columnist, grant winner's profile
Pages 9-11 Concerts & theatre, fun things to do
Pages 12-14 Art programs, nature centers, Zoo discounts, museums
Pages 15-17 Family centers, parenting & breastfeeding
Pages 18-19 Pregnancy & parenting programs
Pages 20-21 Training for childcare providers, Head Start, job training, education, computer & home buyer classes
Pages 22-24 Trading Post/clothing bank, free or low-cost clothing, food pantries
Page 25 Single Mother Want Ads
Pages 26-27 Summer camps, donor/volunteer thanks
Page 28 News, donation request, "Who we are"

Deadlines for news items for upcoming issues:

Dec 4, Mar 4, June 4, Sept 4 email: pbeck@sbcglobal.net

Keep our list updated

Even though you notified the post office with your address change, please call us with your new address! It's very important, and will allow us to continue sending this publication to you for free! Thanks! Call us at 262-251-7333 (or email - see left).

See this newspaper on our web site

Have it at your fingertips, in your computer, for reference! A .pdf of the paper is on our site: www.hopenetworkinc.org

Go green! We can e-mail this paper

Contact us at info@hopenetworkinc.org

Legal help, walk-in clinics

Centro Legal: attorneys provide low-cost representation for family law, criminal misdemeanor cases. 1pm walk-in hrs. on Wed. for divorce, paternity, child placement, or child support issues (1st 20 people are served). 384-7900. 614 W. National

Legal Aid Society free legal assistance for bankruptcy, civil rights, consumer problems, SS/SSI disability claims, healthcare power of attorney, wills, eviction, foreclosure, Municipal Court matters, IRS problems. Walk-in Intake 1:30-3:30pm Mon. & Wed. at 728 N. James Lovell St. Call for other locations: 727-5300

Marquette Volunteer Legal Clinics: Attorneys assisted by Marquette law students provide free, brief legal advice & referrals for non-criminal matters on a walk-in basis. Closed in Dec.

House of Peace 3-7pm Tues. Child support: 5-7pm 1st/3rd Tues
Hmong speakers: 3-5pm 3rd Tues. 1702 W Walnut, 933-1300

United Comm Center 5-7pm Wed. Spanish/English. Child support: 5-7pm 2nd, 4th, 5th Wed. 730 W Washington. 384-3100

Milw Justice Center: 901 N 9. Rm G-9. Th/F 1:30pm sign in; list fills fast; for Milw. Co. 2-3pm Th: landlord tenant matters 278-2910

Help with taxes Taxpayers with a family income of less than \$58,000 are eligible for free help preparing their basic personal income tax returns. The volunteer preparers also point out credits which can help those taxpayers who are eligible: Wisconsin's Homestead Credit; federal and state education credits; and the Earned Income Credit, an often overlooked federal tax break for low-income working people with children living at home.

For a list of what to bring, see www.cr-sdc.org and click on Tax Preparation. It is recommended that you have an appointment to be served at the SDC Super Sites. You may schedule an appointment to have your taxes prepared by calling 206-2262, or on the website: sdc.cascheduler.com

Hours through Apr. 17: 8am-5pm Mon, Tues., Wed. & Fri.; 10am-8pm Thurs.; 8am-1pm Sat. All sites are closed Mar. 30-31.

- SDC, 6848 N. Teutonia
- SDC, 1730 W North Ave.
- SDC, 2906 S 20th St

Other sites with free tax prep:

- MATC Downtown, 700 W. State St. 6-9pm Tuesdays through April 17 (closed April 3) Registration starts 1 hr. before; limited capacity, arrive early.
- MATC South, 6665 S. Howell, Oak Creek 8:30 a.m.-noon on Saturdays through April 14 (closed March 31 and April 7)



**4 Hours, 6 Floors,
100+ Artists
11am-3pm Apr. 14**

See live art in the making. Art exhibitions, film screenings, live performances, & innovative demos by UWM grad students and faculty. Hands-on activities for all ages. 1925 E Kenilworth Place. Free.

Second Saturday family gathering

Join the fun Apr. 14 and May 12! 11am-1pm All Saints Church cafeteria, 4050 N 26. Fun activities, tasty lunch, new friends, free books and gifts. Enter on south side between 25th & 26th. Bus lines 26/62. Free bus picks up at 10:35am at 16th St. Comm. Health Center, 1032 S Cesar Chavez Dr. Returns at 1:30pm. No meetings in June-Aug..

Single moms meet Saturdays in Sussex

THRiVE is a ministry for single moms that meets Sat. a.m. at Oakbrook Church, Sussex. After breakfast, watch and discuss DVD series relevant to self-care and parenting. Free childcare. Register ahead. Visit website for dates and topics: www.oakbrookconnect.org/thrive/ or call Karen 262-389-9499. N64 W22680 State Hwy 74

Where to call for food, help

See p. 22-24 for food pantries, clothing banks

24-hour helpline: IMPACT 2-1-1 To find food pantries, shelter, meal sites, family resources, health & social services:

Dial 2-1-1 (at pay phone, dial free: 1-866-211-3380)

or Text your ZIP code to 898-211 (available 9am-9pm)

or Search the online resource directory at impactinc.org

Live Chat option available online (9am-9pm)

at www.impactinc.org/211/211.htm

Domestic violence 24-hr. hotline: 933-2722

(Sojourner Family Peace Center, which also has a shelter)

Listing of resources in multi-lingual "You Are Not Alone" brochure: <http://tinyurl.com/l4ab2t9>

Also, Milw. Women's Center Emergency Shelter: 671-6140

Waukesha: Women's Center 24-hr. Crisis Line 262-542-3828

Other shelters for mothers & children:

-- Hope House, 24 hrs., 209 W. Orchard, 645-2122

-- Casa Maria, 1131 N. 21, 344-5745

-- Joy House, 830 N. 19, 344-3774

-- Salvation Army, 1730 N. 7, 265-6360

-- Cathedral Center, 845 N. Van Buren, 831-0394

-- Walker's Point Youth & Family Center, shelter for mothers under age 18 with their child, 732 S. 21 St., 647-8200.

Also has transitional housing for homeless mothers ages 18-21 and their children, 672-5531.

Shelter for families (fathers, mothers, children):

-- Family Support Center, 3025 W. Mitchell (call 1st, may be full: 385-0854, choose Option #2)

Parent Helpline, 671-0566

Support groups & classes and confidential phone counseling about

any parenting issue. Referrals to parent education, support programs, home visiting, and community resources

Legal information & referral services -- also see page 2:

Legal Action of WI 278-7722. For MATC students 297-6630

Nonprofit Legal Services of SE WI/Milw & Wauk: 839-8899

Community Advocates: May help with rent, housing, prescriptions, security deposits, utility bills. 449-4777.

Bureau of Milw. Child Welfare, 24-hr. emergency no. to report child abuse for Milw County: 220-SAFE (7233)

WIC supplies food vouchers for pregnant women, mothers with babies under 6 mos., and breastfeeding women of babies up to one year and their children up to age 5. Must meet income guidelines to qualify. 1-800-722-2295

Central City Churches Outreach, 9:30-3 M-Th. Resource referrals. See: "Emergency Food" listing on page 22. Our Savior's Lutheran Church, 3022 W. Wisconsin. 342-1522

Cudahy and St. Francis, zip codes 53110/53235 744-0645

South Milwaukee, zip code 53172 only: 764-5340

Waukesha Co. only: Hope Center, 502 N. East Ave.; furniture, nurse, clothes (casual & career), household items, 5:30pm meal M-W-F 262-549-8726 Hebron House of Hospitality: families/single women shelter, 812 N East Ave, 262-549-8722. Hebron, Siena & Jeremy Houses, no-interest loans, housing specialist, transitional living apts., expedite SSI/SSDI disability 262-549-8720.

Waukesha Co. Food Pantry: 1301 Sentry Dr. 1-3pm M-F, 6-8pm Th, 9:30-11:30am Sat for Waukesha County only 262-542-5300. 1st Call for Help crisis line: 262-547-3388

Keep active, stay healthy!

Spring Yoga Series 6-7pm Mon. April 2-May 7, at Neighborhood House. Reduce stress, build strength & balance. All skill levels welcome. \$5/session; \$25 for 6 classes. 2819 W Richardson Place

Yoga for Families 6-7pm Apr 16, Zablocki Library. Integrates literacy skills, such as love of reading, with other life skills. No equipment necessary. All ages welcome with an accompanying adult

Free annual pass to Riveredge Nature Center to ALL fourth graders. Includes access to trails, programs & festivals, discounts on camps & rentals, day passes for 6 friends/family, 4 day passes to Port Washington YMCA. If your child will be in 5th grade in fall, you can still take advantage of these benefits this summer. Located outside Saukville, a 30 minute drive from Milwaukee. 262-375-2715. Register online riveredgenaturecenter.org/4thgrade.



10am-1pm May 19 at Kosciuszko Park, 2201 S. 7

Bike Day is back! A one-of-a kind community health event for the whole family, hosted by Sixteenth Street Community Health Center.

- Bike parades
- Zumba and Salsa exercise
- Healthy food
- WIC nutritionists
- Bike repairs
- Kids' games
- Safe car seat education
- And more!

Visit all the healthy food, activity, and education stations for a chance to win a FREE BIKE! Other raffles for bike locks and children's bike helmets. Info: 897-5158

Free fishing clinics

April 14 at 9am, 10, 11, noon, 1 or 2pm at park lagoons: Brown Deer Park; Dineen; Greenfield Park; Mitchell Park; Oak Creek Pkwy; Sheridan; McCarty; McGovern; Kosciuszko; Scout Lake; Washington Park; Muskego & Fox Brook Parks (no Wauk. Co. park fee charged); Regner Park in West Bend; Quarry Lake Park near Racine. Ages 15 & under; young children must be w/adult.

Equipment available, but bring rod & reel if possible. Fishing techniques, equipment use, safety, knots, fish ID. 263-8494, 382-7923

Free fishing, admission to state parks

June 2-3: Free admission to all state parks and forests (save \$8). Also, adults may fish anywhere in the state without a fishing license on this weekend, with free equipment available to borrow at many parks. (Kids always fish free.) Free fishing clinics throughout the state. If you're new to fishing, after the free weekend, try the "First-time buyer" license for only \$5. For locations and information, call the DNR at 1-888-936-7463.

Here are activities at two state parks near the metro area:

Harrington Beach State Park: Take advantage of the free admission weekend and visit Harrington Beach. It's north of Port Washington on Lake Michigan. 531 Co Rd D, Belgium. 262-285-3015

-- Free fishing clinics June 2 and 3, between 9am-3pm.

-- Free pancake breakfast 8am-noon June 3 at Harrington Beach. Includes pancakes, sausage, coffee, juice, milk, and applesauce.

Kettle Moraine State Forest/Lapham Peak:

W329 N846 County Rd. C, Delafield. 262-646-3025.

June 2: Bike Swap & Fun Fair 9am-2pm at Homestead Hollow. Free. Children's activities, vendors, food for sale, and new and used bikes to purchase. If you'd like to sell a bike, it's a \$10 fee (if your asking price is \$150 or less).

Lapham Peak is also a great place to hike, with a fun-to-climb 45 ft. observation tower. Seven miles west of Waukesha.

MPS Recreation programs for families, teens, young adults

Wellness Days -----

Free drop-in family programs for ages 6 and up. Free healthy snacks. Registration accepted on a first come, first served basis at the event.

Citywide Wellness Day, 6:30-8pm Mar. 24 at Madison, Bay View, and Washington. *Family Spring Egg-stravaganza* with egg hunt, egg coloring, cupcake decorating, arts & crafts, games, healthy snacks, prizes, and wellness/fitness activity.

Spring Wellness Days, 6-8pm Info: Erica, 475-8775.

Apr. 25 at Washington: healthy cooking demo, hip hop dance, etc.

May 30 at Obabma: hip hop, dodgeball & more

June 23 at Washington: healthy cooking demo, hip hop, soul line dance, water aerobics.

Twilight Centers -----

Safe places for teens to hang out with their friends. 6-9pm Mon. and Wed. and 6-10pm Sat. For ages 12-18. 475-8811.

- Barack Obama School
- Bay View High School

- James Madison Campus
- Pulaski High School
- North Division High School
- South Division High School
- Washington High School

Drop-in: open gym, game room, open swim, college access programs, girls' Star Program, social seminars, music production, cooking classes, creative arts, dodgeball league, cultural outings & more.

Family special events some Saturdays, such as Egg-stravaganza at left (Wellness Days). Info: 475-8811

Free Fitness Sampler -----

Have you ever wanted to try a Milwaukee Recreation fitness class? This is your chance to try it for free. During the Spring Fitness Sampler Day, try a variety of adult fitness classes, and determine which is best for you. Register at 10am. Coupon allows you to register, that day, on-site, for a free 2018 Spring class at any location. 475-8775.

10am-12:30pm Mar. 24 Riverside High School

10am-12:30pm Mar. 24 Milw. Marshall High School

Looking In, Looking Out

*A column by
HOPE Network
founder
Gail Grenier Sweet*



Two old war horses take a hard look at HOPE Network

For four months, former executive director Pauline Beck and I have “held down the fort” at HOPE Network. We are happy to be here, although neither of us had expected to be back in the former elementary school building of Good Shepherd Parish in Menomonee Falls, at the HOPE office we’ve had free of charge for more than three decades. I tell friends that we “two old war horses” are back at work, filling in while the office is in transition. We may be tired a lot of the time, but things happen every day that restore our belief in HOPE, in people, and in the future

First job: find a leader

Soon our board will select HOPE’s new executive director “What?” you may ask Yes, we happily announced, in the last issue of this news magazine, that we’d found our new exec after the untimely death of Rachel Holley Sciortino, who served as E.D. from the summer 2017 until she died in an accident in October. Unfortunately, our new hire changed her mind about accepting the position after our announcement ran.

Sigh . . . back to square one, searching for HOPE’s head staffer – for the third time in less than a year. Luckily, we’ve received many applications from wonderful candidates. Brilliant and talented people are eager to work for such a life-affirming organization as HOPE Network for Single Mothers. By next issue of this *News*, our new exec and her new assistant/office manager should be hard at work. (And Pauline and I can go back to semi-retirement.)

Second job: evaluate ferociously

With every challenge comes a blessing. It has been so for Pauline and me. During these four months, we’ve had a chance to examine and evaluate every single program and process. “Do we need this?” “How could we do this better?” “How does this relate to our mission of helping families headed by single mothers?” “How can we make the best use of our money?”

Only good will come of this deep and relentless examination.

Third job: continue outreach

Pauline and I have had heartwarming contact with mothers of HOPE Network, with agency representatives who help them, and with our community partners

* There was the mother who came into the office with her twins; she had split from the babies’ father when he asked her to abort them and wait to conceive when they could “better afford” a baby.

* While I was helping her gather some used clothing, a community volunteer stopped by to donate formula that happened to be the exact type used by those twins. Smiles all around. When the mother left, she turned in the doorway and said to me that she plans to pay

it forward, that when she gets back on her feet again and has a bit of money, she’ll donate to HOPE Network.

* There was the woman who began a mentoring program out of her home, also supplying free diapers and wipes to mothers in need from the cash in her own pocket. She came by to pick up some extra diapers HOPE had on hand. She gave me a big hug.

* There was the nurse who generously provided safe sleep education to mothers when our regular educator had to step down due to health concerns.

* There was the new HOPE member who was due in three weeks and came into our office to get a layette. Her eyes welled with tears when she saw the quilted baby blanket and the hand-crocheted baby afghan in her layette; she was overwhelmed with the kindness she was being shown.

* There was the grandmother who is raising her grandchild and drove here from West Bend, and despite heavy snowfall that morning, was early for her crib appointment. We not only gave her a layette, crib, safe sleep education, and car seat, but hunted down other resources for her in Washington County.

Fourth job: thank our amazing volunteers

It’s been remarkable the way our volunteer board of directors and community volunteers have jumped up to help keep HOPE afloat. They do so cheerfully, without expecting accolades

* There was the volunteer who for hours fought the computer program that repeatedly refused to let her change information on members’ addresses. This problem happened after we paid for a bunch of newspaper returns because they hadn’t been addressed just right for bulk mail.

* There were the office volunteers, doing mailings and providing all sorts of other help . . . including encouragement to beleaguered Gail and Pauline through the holiday rush.

* There was the board member who spent hours going through HOPE’s tax papers and budget, also stepping forward in the office to show a mother how to fold and unfold a used stroller.

* There are the volunteers who continue to make up the layettes and sew the beautiful cloth tote bags . . . we’re happy to tell them of the mothers’ gratitude for such lovely new items.

* There is the group of women who form our selection committee, gamely working for the third time to find the brightest minds to work in HOPE’s office, best helping the families we serve.

THANK YOU THANK YOU THANK YOU TO ALL!!!

Founder’s book sales benefit HOPE

Gail’s books are available from Amazon.com, or at the HOPE Network office in Meno. Falls (8-12:30 M-Th): Calling All Horses (\$9), Dessert First (\$13), Dog Woman (\$10), Don’t Worry Baby (\$13).

For more info or to have her speak at your book club, church or civic group, contact her at gsweet@wctc.edu



Select us as your charity, shop at AmazonSmile, and they’ll donate 0.5% of the price of your purchases to us. It’s the same as shopping with regular Amazon, except we benefit each time you purchase! Go to smile.amazon.com. When prompted for the charity name, enter our IEN number: 39-1475304. You may also enter HOPE Network but there are other charities with the same name.

Resources in Waukesha County



Retzer Nature Center family fun on p. 13.

La Casa De Esperanza Early Head Start

Free program for families with incomes at or below the federal poverty guidelines. These services are for pregnant mothers, and for families with infants to age 3. Special disability accommodations. Free services: parent education, health info, individualized support, disability services, nutrition education, and social activities. 410 Arcadian Ave. Contact Mary Beth 262-832-1575.

Financial, homebuying resources:

Money, home buying workshops Call for dates of next free classes at Center for Financial Stability at La Casa De Esperanza, 202 E Broadway, Waukesha. 262-832-1570.

Negotiating Your Lease effectively negotiating terms & landlord/lessee responsibilities. 6-8pm Apr 16 6-8pm, Waukesha State Bank, 151 E St Paul Ave., Waukesha. Free. Info: WWBIC, 263-5450

Housing Resources offers **Homeworks Workshops for first-time homebuyers**. Real estate experts help buyers avoid common pitfalls when buying homes. Learn to improve credit, maintain savings, and budget. Hear about grants to help with down payment and closing costs. 10am-4pm Mar. 17, Apr. 14, or May 26 (choose one), Register: 262-622-1230 or visit www.hri-wi.org. At 217 Wisconsin Ave. #411, Waukesha. HRI is a HUD approved organization.

Waukesha food, clothing, resources

Waukesha Co. only: Hope Center, 502 N. East Ave.; furniture, nurse, clothes, household items, 5:30pm meal M-W-F 262-549-8726 Hebron House of Hospitality: families/single women shelter, 812 N East Ave, 262-549-8722. Hebron, Siena & Jeremy Houses, no-interest loans, housing specialist, transitional living apts., expedite SSI/SSDI disability 262-549-8720.

Waukesha The Clothing Shop has casual clothing & career-type clothing. For residents of Waukesha Co. M-F noon-4pm, Tues. & Sat. 9:30-11:30am, and Wed. 6:30-8pm. HOPE Center 502 N. East Ave., 53186. 262-549-8726

Waukesha Co. Food Pantry: 1301 Sentry Dr. 1-3pm M-F, 6-8pm Th, 9:30-11:30am Sat for Waukesha County only 262-542-5300. 1st Call for Help crisis line: 262-547-3388

Waukesha St. Vincent de Paul Thrift Store, S30 W24836 Sunset Dr., 9am-8pm Mon.-Sat.; 11am-6pm Sun. 262-547-3281

Sussex-Area Outreach Services (SOS), in Civic Center Bldg, N64 W23760 Main St., Sussex. 5:30-7pm M 1-2:30pm W 10-noon Sat. Clothing bank household & small appliances. Must live in Hamilton school district. Food pantry/emergency services. 262-246-9860

Lake Country Caring: for Waukesha & Washington Co. residents only. Free clothing, household, and some furniture. 9-noon Tues/Thurs/Sat; also 6-7pm on 1st Thurs. Call 1st. Must have proof of residency & need. 603 Progress Dr., Hartland. 262-367-6670

Parents Place - Waukesha

1570 E Moreland, Waukesha. Register for classes, free childcare, 262-549-5575. Fees may be reduced or waived.

Love and Logic: Become a Love and Logic parent and unlock the secret of successful parenting with these effective techniques. Mondays, April 9, 16, 23, 30 from 5:30-7:00 pm

Big Emotions - Meltdowns and Tantrums: Wednesdays, April 11 from 5:30-7:00 pm

Everyday Learning Series: Play/Read. This group will allow you to create a book with your child. Wednesday, April 11 from 5:30-7 pm

Special Workshop with Karen Becker: Mindfulness. During this discussion, we'll talk about ways to incorporate mindfulness in your family life as well as your personal life. Tues. Apr 17 from 5:30-7pm

Everyday Learning Series: Music/Movement. Create instruments and learn the importance of music in your child's life in creating calm Wednesday, April 25 from 5:30-7:00 pm

Co-Parenting: Mondays, March 12, 19 from 5:30-7:00 pm

Kids Managing Anger (Parent and child class) Mondays, March 21, 28 from 5:30-7:00 pm

TRIPLE P - POSITIVE PARENTING PROGRAM

A one on one or small group program based on the individual needs of each family. Meets Monday-Thursday, Days & Evenings. Call Parents Place to sign up.

PLAYGROUP: A free on-going group for parents, grandparents, primary caregivers and children. Every Wed. from 9:30-11 a.m.

The Women's Center - Waukesha

505 N. East Ave, Waukesha. 262-547-4600

24-Hour Hotline: 262-542-3828 or 888-542-3828

Open to all, including adult, child, & teen survivors of domestic & sexual violence. *Family Support Project* provides free counseling for stress/anger management, child development, positive parenting & life skills. Free childcare available. Call for workshop and support group topics, 262-547-4600, or visit www.twcwaukesha.org

- See **Employment & Life-Skills** on p. 21.

Low-cost dental care for Waukesha Co.

Waukesha Co. Community Dental Clinic provides dental care to low-income, uninsured and under-insured children and adult residents of Waukesha Co. For appts. for children, call 262-522-7645 ext. 221. 210 NW Barstow St., Ste. 305, Waukesha

Child health & parenting services are provided free by the home visiting nurse program of the Waukesha Co. Public Health Dept.. Nurses can make referrals and help you with health care, dental care, counseling, transportation, and WIC nutrition. 262-896-8430.

Are you pregnant? Prenatal Care Coordination helps women gain access to medical, social, educational and other services during pregnancy. Call Waukesha County Public Health, 262-896-8430.

Waukesha WCTC free High School Equivalency Diploma (HSED) & GED, English Language Learning (ELL) classes. Open to all. 327 E Broadway, Waukesha. To get started, call 262-695-6500.

Stop smoking program Quit smoking with free total-health approach program. 6-7pm 8 Tues. at Waukesha Memorial Hospital. Register online prohealthcare.org or 262-928-2745

Gramma Duty

A note to single grandmothers...

by Pamela Oberg-Sutton
aka Grammy Pammy



Pam, at one of her favorite places: the Butterfly Garden at the Public Museum. Free on April 5, May 3, & June 7.

Thank you!

I feel like I never say it enough.

Many days go by and I intend to send thank-you cards or make phone calls, but there never seems to be enough time in the day!

So today I'm going to try and say thank you to some of the people I may have missed. Unintentionally!

I'll start back when my grandchildren came to live with me from Phoenix. They were coming out of foster care, and were sent with literally nothing.

No diapers, no bottles, no clothes.

Mind you, the little guy, who we call "the boy," was only 17 months old. I landed back at Mitchell Field with a suitcase full of nothing but garbage and junk.

I worked for a company that denied my FMLA [Family Medical Leave], and later I found out that I was entitled to it, too. Needless to say, I had no time off to settle us in.

So first, I want to thank my good friend Linda D. who came through with clothes and toys, and a whole lot of moral support! I could not have done it without you, Linda! You have been there through thick

and thin. We've laughed and cried many a time. You were always there, and I appreciate you for being my friend.

Thank you to Barb C. for all the nights you babysat when I was working third shift. Also, thanks to MATC's childcare staff who worked with me and kept my grandchildren happy and content, while I slept.

Thank you to Ebenezer Childcare, who took over the job when we added Cortez to our family.

Thank you to all the teachers at Ideal School, St. Marcus, and St. Philip's. I just can't thank you enough.

Thank you to Big Brothers/Big Sisters, for always sending such wonderful people into our lives! Thanks to the "Bigs" who took the time to mentor my children. To Katie and Jason who moved away, but still stay in touch -- it all means so much -- thank you!

Thank you to HOPE Network, for all the things you have to offer. I enjoy the Brewers games, the Bucks games, and all the activities that you share with us single parents. There is always something going on in Milwaukee, and HOPE Network will not only find it, but they'll tell you the best way to do it too! Thank you for all your hard work.

Thank you to Lake Valley Camp, for all the opportunity you have offered to us over the last several years. From day camp to family camp, for fun and fellowship, it's been a blast and I am so grateful to all the staff.

I'm sure I missed a few thank-you's still, but know that you're in my heart, and without good friends and people we can all rely on, including my God, we are nothing.

Have a great spring, as I know we're all looking forward to it, and remember, it's never too late to say THANK YOU!

Wellness and health resources

- Community Outreach Health Clinic, Menomonee Falls provides non-emergency medical and pharmaceutical care to **uninsured and under-insured patients**. This includes treatment, dental care, prescriptions, laboratory tests, and wellness education and counseling. Patients must live in the service area of Community Memorial Hospital, which covers 29 zip codes (in Milwaukee, 53222 thru 53225 are served). To be eligible, income must not exceed 250% of the federal poverty guidelines.

Although services at the clinic are free, a \$10 donation is requested from each patient at each visit. The clinic is located in the Outpatient Care Center at Community Memorial Hospital, W180 N8085 Town Hall Rd., Menomonee Falls 53051. Hours: 5-9pm Tues. & Thurs. Drop in, or call 262-257-3393 to schedule an appointment.

- Free Saturday Clinic for the Uninsured provides free health care through a team of physicians & medical students at Columbia St. Mary's Family Health Center every Sat from 8-11am. Walk-ins 1st come/1st served with many registering by 7am. Care includes pharmacy, lab services, mammograms, well-women visits, referrals to specialists, dental hygiene services, diabetic eye screenings Call 588-2865 for pediatric appts (<18 yrs) or more info. 1121 E. North Ave.

Be Strong, Stay Strong *strength training course* Mar 28-June 1, 9-10:15am, Wed & Fri Community Memorial Hospital, Menomonee Falls \$20 (fee is reduced from \$30, based on need). Bone and muscle loss begins early, and this strength training can reverse the process. Other benefits: reduced risk for diabetes, heart disease, depression. For info or to register, contact: Jen Whitty 262-548-7789.

Sankofa Health and Wellness Forum

9am-2pm Apr. 28 Health education, nutrition, and CPR demos; Kids Zone: face painting, games, activities; free healthy breakfast (9-10am) and lunch; early-bird door prizes at 9am; on-site job interviews. No need to register. North Division High School, 1011 W. Center. Sponsor: American Cancer Society; info: 877-940-7848

Stop smoking program *Free educational class* to establish a plan to stop smoking: noon-1pm one Wed. per mo., Wheaton Franciscan Family Care Center, 2400 W. Villard. Call for dates: 527-8237.

First Breath helps pregnant women, new moms, and their family members quit smoking

First Breath participants receive free one-on-one counseling and support from a trained Quit Coach. Services include: home visits, phone calls, text message support, and smoking breath tests (to monitor progress). WalMart gift cards distributed for completing sessions

Interested in joining First Breath? Ask your doctor or nurse, or contact the Wisconsin Women's Health Foundation, 1-800-448-5148 or www.joinfirstbreath.org.

Healthcare providers interested in referring their patients or clients to First Breath should refer to www.providefirstbreath.org.

Have a healthy, alcohol-free pregnancy with help from My Baby & Me

My Baby & Me participants receive free education and text message support from a trained pregnancy educator. Women who need extra help can receive free one-on-one coaching from a trained specialist. *Interested in joining My Baby & Me?* Ask your doctor or nurse, or call the Wisconsin Women's Health Foundation, 1-800-448-5148.

Grant winner: Arvel Cousins



By Emily Gierlach

Arvel Cousins is a single mother to two wonderful school-aged children and one adult child. “My Andrea is 25, and she just graduated with her bachelor’s degree! And she is going on to pursue her master’s!” Arvel proudly told HOPE Network.

Arvel herself is just three classes away from graduating with a bachelor’s degree in human services from Upper Iowa University, and that was no easy feat. “For most of college I was working three part-time jobs just to pay the bills. I somehow got it down to just two. The dream now is just one full-time job, with a specific schedule.”

Teen Job Centers at the library

Need help finding a job or creating your resume? Drop by library Teen Job Centers for helpful tips, access to a computer, and assistance with applying online. You will need to know your social security number. For ages 15 and up.

-- Martin Luther King Library 1-3pm Mar. 26

-- Villard Square Library 2-4pm Mar. 26 and Mar. 29

-- Atkinson Library 2-4pm Mar. 27

Acing the Interview 4-6pm Mar. 21, Washington Park Library
Tips for teens on what to do before, during, and after the interview. Friendly professionals will be offering mock interviews in a low-pressure environment.

Teen Job Fairs & Resume Workshops

Both summer and year-round employers will be ready to meet teens and give them job applications. Attendees should come prepared with a resume and business-appropriate dress attire. For ages 16-19. Resume help will also be available. View list of on-site employers at mpl.org/TeenJobFair

-- 2:30-4:30pm Mar. 27, Mitchell Street Library

-- 2-4pm Mar. 28, Washington Park Library

She’s no stranger to hard work, as 20 years ago she achieved an associate’s degree in marketing, but stopped her career to “focus on my oldest.” Putting school aside seemed like a logical move. Arvel instead wanted “to be the best mom I could be.”

Despite her work load and unrelenting schedule, Arvel also was awarded an associate degree in human services, and so powering through for a bachelor’s seemed both natural and logical. “I did not plan my pregnancies, but that did not mean that I should not be diligent and take care of business. It is my job now to attain a stable income from me AND my children. They are my best motivators.”

Her goals post-grad are to work as a case manager for troubled youth, making sure they “stay on track.” Or, Arvel would like to work in the W-2 Program, drawing from her own experiences. “I know what it’s like to be struggling. I was always helping other people look for job openings like I had done. Or, I would have them send me their resume to look over. Why not make it a job?” Her ultimate end goal – not surprisingly - is to get her master’s in social work.

Besides her oldest, Andrea, she has Chantel, 10, and Xavier, 9. “Oh, they’re a handful!” Arvel laughed, but they remind her it’s important to have fun. “I’m not an outdoorsy person, but somehow they are. Just recently I took them snowboarding and they loved it! I stayed in the car, of course, but at least they got to have a great time.”

In her spare time, Arvel enjoys watching movies and trying to relax. “I also love cleaning the house and quiet time, but I really enjoy just letting my kids be kids, taking them out to restaurants and fun places. Just this past weekend we saw *Black Panther*. I think it’s important to try to do things for myself, for them, and for us as a family.”

Arvel’s advice to other mothers is simple: “It’s never too late to get your act together. When opportunities come, use them as stepping stones. You can always do better. You have to be willing to put in the work; stay on the grind, but you can get there. I wanted my kids to see that, and now they will!”

Congratulations, Arvel!

Get a raised-bed garden from Victory Garden Initiative

These 4x8-foot raised-bed gardens are installed where



you want them! Volunteers construct the garden and fill it with healthy, organic, compost-based soil. Order one for your front yard, backyard, school or place of worship – anywhere you want to grow your own food. Gardens will be installed May 12-26 during the Victory Garden BLITZ. **Discounted gardens** for certain neighborhoods will be announced in April. To find out if you qualify for a discounted garden or for more info: call 727-2292 after April 12 or go to: www.victorygardeninitiative.org/BLITZ

Betty Brinn Children's Museum

Neighborhood Nights FREE admission, from 5-8 p.m. on the third Thursday of every month: Mar. 15, Apr. 19, and May 17.

Enjoy access to all of the Museum's hands-on exhibits, and stop by the Be A Maker space to find tools, materials and techniques for endless ways to experiment and create.

Special performances of *A Busy Bee* with the Florentine Opera Company (see below) 1-2pm and 2-3pm Mar. 27.

Tot Time: Every Thurs., 10:30-11am. Songs, stories, games and other activities for ages 1-3

Pint-Size Science: Mar. 20, Apr. 3, 17: 10:30-11am. Hands-on science discoveries thru stories, songs and experiments for ages 2-5.

It's In the Bank! Mar. 26, April 9 & 20: 11:30am. Children age 4 and older will learn about earning, spending, saving, and sharing.

Museum Swap Day: If you have an annual membership to Betty Brinn, you may use it to go to other museums for free on May 6.

929 E Wisconsin, 390-5437. Regular admission: \$8 per child or adult; \$7 for ages 55+; children age 1 and younger are free.

Family Focus free membership at the Betty Brinn Children's Museum

Family Focus memberships provide free access to the Museum, along with additional support for caregivers, including free parent engagement programs and transportation assistance.

We encourage families to apply for the membership and to sign up for a Family Focus Orientation by visiting our website at: www.bbcmkids.org/family-focus-membership/ or by calling: 390-5437 ext. 228 or 226 for Spanish.

Museum Swap Day

If you have an annual membership to Betty Brinn Children's Museum (or the other sites listed below), you can visit other museums for free on Swap Day, May 6. Go to the Charles Allis Art Museum, Grohmann Museum, Milwaukee Art Museum, Milwaukee Public Museum, Villa Terrace Art Museum or Pabst Mansion. (Discovery World is not included.)



The first Promise Zone Bike Ride in 2017 went through some of Milwaukee's historical and industrial areas, connecting residents and launching the Promise Zone's efforts to affect positive change.

Annual Promise Zone Bike Ride

10-noon Saturday, May 12

Join us for a slow-paced, family-friendly 5-mile bike ride through parts of Milwaukee's 30th Street Industrial Corridor and the surrounding neighborhoods. All ages are welcome!

The ride will start and end in Garden Homes Park, 2600 W. Atkinson Ave. Free and open to all.

DreamBikes will bring a mobile repair unit to do some free light tune-ups and fill up tires for bikes that haven't been used for awhile.

Event sponsors include: Northwest Side Community Development Corp., The Corridor Corp., Black Girls Do Bike, Wisconsin Bike Fed, DreamBikes, and Uniting Garden Homes.

(DreamBikes is a nonprofit bike store that accepts gently used bicycles, parts, and accessories. Their trained DreamBikes teens refurbish and re-sell the bicycles back into the community at affordable prices. 2021 N. Martin Luther King Dr. Phone: 763-0909)



Illustration by Francisco X. Mora

Take your family to see *A Busy Bee*

This children's opera will also be performed 10:30-11:15am Mar. 27 at the Central Library downtown Milwaukee. Free.

Free performance of *A Busy Bee*

12:30pm April 7 at Family Day at the Florentine Opera Center

The Florentine's world-premiere children's opera, *A Busy Bee*, brings to life the story of Bella the Honeybee. For families with children ages 5-10. Free, no RSVP required, but seating is limited. Length: 35 minutes, followed by a brief question and answer period. 930 E. Burleigh St.

HOPE Network readers save \$5

Children's Theater at Wilson Center

6pm April 21 *A Busy Bee: The Story of Bella the Honey Bee*
Meet Bella! She's bright, she's brave, and she's not afraid to try, try, try! A collaboration between Florentine Opera Company and SHARP Literacy celebrates the importance of teamwork, respect for others, and never giving up. For families with children ages 5-10. HOPE Network discount code: HOPE1718BEE. Sharon Lynne Wilson Center for the Arts, 19805 W. Capitol Dr.

For tickets, call 262-781-9520, visit www.wilson-center.com, or stop in at the box office between 11am and 6pm.

Betty Brinn Children's Museum

Special performances of *A Busy Bee* with the Florentine Opera Company 1-2pm and 2-3pm Mar. 27. For families with children ages 5-10. Free with regular museum admission, but registration is required. Visit the Museum's Information Desk for more information. 929 E Wisconsin, 390-5437. Reg. admission: \$8 per child or adult; \$7 for ages 55+; children age 1 and younger are free.

Take in a play!

First Stage Children's Theatre - Todd Wehr Theater Marcus Center
The Wiz, based on beloved TV classic, thru Mar 25.

Antarctica, WI, When a special boy begins to see icebergs floating into Milwaukee, he alone must find a way to help his community navigate through the dangerous waters. Apr 6-22. Ages 10-17. Pay-What-You-Choose 7pm Apr 10. **See Judy Moody at right.**

Pay-What-You-Choose at First Stage: minimum is \$5 for adult or child; purchase in advance by phone: 267-2961 (must mention "Pay-What-You-Choose") or at door (arrive early; doors open at 6pm)

Sensory Friendly Kits: For those on the autism spectrum or with other sensory or cognitive disabilities, First Stage has kits to use during plays, with a story about going to the theatre, fidget toy, and noise-cancelling earmuffs. Ask the theater house manager for a kit.

Children's Theatre of Wauwatosa: *Tak for Troll Tales*, Mar. 24. 2pm, box office opens at 1:30pm. Ages 2-12. Admission: \$5. Longfellow Middle School, 7600 North Ave. Groups welcome, including birthday parties, but call in advance. 527-0198

Milwaukee Youth Theatre: *The Princess and the Pea*, Apr 26-27, May 4, 7pm. \$11 adult/ \$9 ages 13-17/ \$7 age 12 & under. Lincoln Center for the Arts, 820 E Knapp. 390-3900.

Sunset Playhouse: *Into the Woods, Jr*; 6:30pm Mar. 18-19. \$11 adult/ \$7 ages 3+. *Animal Tales: Aesop's Fables*, 10:30am, additional show 2pm Sat, May 12. \$10 adult/ \$5 ages 3+ 800 Elm Grove Rd, Elm Grove. 262-782-4430

In Tandem Theatre: *The Fantasticks*, Apr 26, 7:30 pm. Enjoy this whimsical, funny and romantic musical about a boy, a girl, a wall and two fathers whose plans to bring their children together is by keeping them apart! Tickets are Pay-What-You-Can for this performance. 628 N. 10th Street. 414-271-1371.



Kids Play for Kids

7-8pm May 16

FREE!

Festival City Symphony

In addition to music by the orchestra, the concert will feature solo and ensemble pieces performed by local students. Children from the audience will have an opportunity to conduct the orchestra's finale.

Attend in casual dress or pajamas. Bring a blanket and sit on the floor, up close to "meet" the orchestra; regular seating is available. Best suited for K4-5th grade. May 16, 7pm, Bradley Pavilion Marcus Center. Enter through the main entrance, 929 N. Water St. If park in the Marcus Center lot, use the third level skywalk. 365-8861

Jazz Jam at the Wis Conservatory of Music 7-9pm April 13 & May 11. Come and play or just hang out and listen in a fun, musical environment hosted by faculty. Free. Open to high school & adult musicians of all skills Drums, piano, vibes, bass amps, guitar amps, and vocal P.A. provided. 1584 N. Prospect Ave.



At First Stage Children's Theatre:

Judy Moody and Stink: The Mad, Mad, Mad, Mad Treasure Hunt, based on children's books by Megan McDonald. Ages 5-9+. May 4-June 3.

Pay-What-You-Choose performance: 7pm May 8

Saturdays at Central for kids: fun drama presentations. 10:30-11:30am Central Library, 814 W. Wisconsin Ave. Free.

Mar. 17: Sunset Playhouse presents *Caps for Sale*. Story goes behind the scenes to weave the tale of a cap peddler's life, some monkeys and their monkey business.

Apr 14: First Stage Children's Theater presents *Judy Moody and Stink and the Mad, Mad, Mad Treasure Hunt* (also see above)

Apr 21: Milwaukee Youth Theater gives a preview performance of *The Princess and the Pea*. Also, theater games for all ages. See left for dates of actual performance.

Inexpensive plays for adults, teens

Pay-what-you-can nights: pay at the door; 1st come, 1st served. Be there early! Also see *The Fantasticks*, above.

Milw. Rep: *Our Town*, illuminates the powerful bonds that hold communities together. With humor and wit, Wilder delivers universal truths about what it means to be human and encourages us to live life to its fullest, Apr 10-11. 108 E. Wells. Box office opens 5:30pm; shows at 7:30pm. 224-9490

Next Act Theatre: *I and You*, a mystery that is an ode to youth, life, love, and the strange beauty of human connectedness, 7:30pm Apr. 23. 255 S. Water Street

Free reading by the Milw. Rep of *The Thanksgiving Play* by Larissa Fasthorse 6pm Mar 19 at Mitchell Street Library. A satirical comedy about mismatched artists attempting to devise an ethnically sensitive play for the local schools to celebrate both Thanksgiving and Native American Heritage Month. 906 W Historic Mitchell St.

All-City Arts Festival May 9-11 at Summerfest grounds. Music, dance, art, spoken word & theatre by elementary, middle, and high school students. Free & free parking. www.mpsmke.com/yota

Affordable classical music

Symphony Sunday: Festival City Symphony

March 25: *Passion, Beauty, and Light* Music by three of the finest French composers: Faure, Debussy, and Bizet.

May 13: *Legends and Masters* "Prelude to Hansel and Gretel" and other pieces bring folktales to life.

3 pm performances. 2:45pm children's program notes in east lobby; conductor also comments in concert. \$14 adults/\$8 kids & seniors Pabst Theater, 144 E. Wells. 286-3205

Fun things to do

Milw. Co. Parks Information: 257-7275

Free or reduced admission days for Milwaukee County residents with proof of residency:

- The Domes: 9am-noon Mon. (except holidays eg: Memorial Day)
- Zoo: see Zoo article on p. 14 for free days & reduced rates
- Boerner Botanical Gardens: 1st Tues. of the month starting in May

Free to anyone; need not be Milw Co. resident:

- Milw. Public Museum: Free 1st Thursday of month
- Art Museum: Free 1st Thursday of the month

Legos and Animation: noon-4pm Mar. 24. Workshop participants can create with Legos and K'nex and then include in a stop-motion animated short. Fun for the entire family. 6th annual event led by John and Sylvia Peine. Workshop free with museum admission of \$5 adult, \$3 students/seniors (under age 12, free). Also, view LEGO animated features. Grohmann Museum, 1000 N Broadway. 277-2300

Easter Egg Hunt, 11am Mar. 24. Humboldt Park, 3000 S. Howell, on the west side of the Pavilion. This free event will feature 5,000 eggs and a designated area for each of 5 age groups (ages 1-12). Bring a non-perishable food pantry donation.

Milwaukee Public Museum

Free admission to all on 1st Thursday of the month.

Open 'til 8pm that night (although butterfly wing closes 4:30pm)

Milw. County residents with ID get \$2 discount every day.

Free to: moms on Mother's Day, dads on Father's Day, grandparents on Grandparents Day, and veterans/members of the military on Memorial Day & Veterans Day. 800 W Wells. 278-2728.

Mar. 17: Trinity Irish Dancers, 1-1:30pm, then free Irish dance lessons. **Spring Break** March 26-30, special activities 11am-3pm

Maya: Hidden Worlds Revealed

Largest exhibition about the ancient Maya ever to be displayed in the US. With hundreds of authentic artifacts, immersive environments, multimedia, and hands-on activities, this exhibit is designed to give visitors a glimpse of a cross-section of Maya life. Runs thru May 28.



Special exhibit cost, which includes admission to the entire Museum and Planetarium, is \$25 for adults, \$16 for ages 5-13. Children 4 and under are free.

If you go on the first Thursday of the month (free day), your only expense is \$7 (adult) for the special exhibit and \$4 (youth).

Also, if you participate in Museum Swap Day (see p. 9), your expense would be \$7, if you have another museum's annual pass. If you go on the busy free days, you may wish to call ahead to purchase tickets and reserve your entrance time.

Milw. Museum Mile Day: Free admission 11am-4pm May 13 at Charles Allis Art Museum, Jewish Museum, Museum of Wis. Art at St. John's On the Lake, & Villa Terrace, and half price at North Point Lighthouse. Museums close to each other on East side. Kids' activities. Free shuttle. See www.milwaukeeuseummile.org

Family Kite Festival

Veterans Park: 10-6 May 26 & 10-5 May 27.

Bring a kite! Grand Launch of 500 kites on Sat noon. Kids only: Make a Kite 1-3pm Sat.

Kids Mad Dash of 100 kites at 2pm.

Giant kites & other performers.

1300 N. Lincoln Memorial Dr.

Sponsor: Gift of Wings, giftofwings.com, 273-5483. Free.



Harley-Davidson Museum: Visit for free as part of Gallery Night 5-9pm Fri. Apr 19. Reduced rate of \$10 on Tues. thru April. Reg. cost: \$20 adults/\$10 kids 5-17/under 5 Free. 400 W. Canal. 287-2789

Falls Memorial Fest: 11am-10pm, May 26, downtown Menomonee Falls Street party on Main St. between Appleton & Water, live music, car show, booths, Ducky Ducky Derby, children's area, Run/Walk.

Science Bag free series of interactive performances; ages 8+ that connect science to everyday life. Room 137 UWM Physics Bldg., Kenwood & Cramer St 229-4561. Note NEW 7pm time. *Migration of Modern Humans*, Mar 16, 23 & 30 at 7pm; *Remembering and Forgetting*, April 6, 13, 20 & 27 at 7pm, & April 15 at 2pm

Movie environments for special needs children

"Reel Movies for Real Needs" features family films in a low sound volume environment with brighter lighting for children with autism or other needs who may not be comfortable at a regular screening. 10:30am Sat. at North Shore, Mequon; The Ridge, New Berlin; and South Shore, Oak Creek.

Mar 24: *Sherlock Gnomes*

Apr 21: *Duck Duck Goose*

May 5: *Avengers: Infinity War*

May 26: *Solo: A Star Wars Story*

June 16: *Incredibles 2*

Community meetings, career development

Fellows and Facilitators

Evenings will include true, personal stories from ExFabula fellows, community members who have worked with storytelling coaches to craft personal stories about current issues. Listen to stories and then share your own observations in small group listening circles. FREE.

Talking to Your Kids about Race: April 3, 5pm check-in, 5:30pm meal, 6-8pm program. Christ Church, 5655 N. Lake Dr. Whitefish Bay. Come hear stories about talking to your kids about race, and participate in dialogue circles.

Housing as a Public Health Issue: April 12, 5pm check-in, 5:30pm program, Zilber School of Public Health, Rm 119, 1240 N 10. Come hear stories on housing and public health. Stay for our dialogue circles. Free, but may register at www.exfabula.org/tickets/

More info: check the websites of ExFabula or co-sponsor Zeidler Center for Public Discussion closer to events. www.zeidlercenter.org

2018 Health Equity Summit: Zip Code and Children's Health. Busting myths. Reimagining solutions.

8:30am-2pm, Apr. 26. Italian Community Center. Panels, discussions followed by working on a tangible execution of action plans. \$25 inc. light breakfast & lunch. Register: www.ssche.org

YPWeek for Young Professionals: Apr. 20-28. Professional development workshops/interactive activities, reverse job fair, social events, and more. www.ypweek.com

ART workshops ART jamborees ART camps

Walker's Point Center for the Arts

839 S. 5 St. www.wpca-milwaukee.org

- FREE After School Art Classes

3-6pm Tues.-Fri.. Open to students of all abilities, ages 6-12. Must register at 1st drop-off, or in advance online. Weekly projects explore painting, drawing, clay, printmaking, or fiber arts.

- **Afternoons with Art (AWA)** On days when MPS is closed for ages 6-12, WPCA offers programming. Programs range from \$5-\$20 depending on what is being offered. Class size is limited; advance registration is highly recommended. More information can be found at: www.wpca-milwaukee.org

- Spring Break's Youth Empowerment Week March 26-30

Week-long workshop to explore identity, community, and self-advocacy through creative expression. Each day students will create a project using different artistic mediums. Prices: \$30 – \$60/week.

Discount for 53204 neighborhood residents and WPCA members. Daily rates also available. 1-5pm. For ages 6-12. Contact Basha Harris, arts education coordinator, 509-6187 basha@wpca-milwaukee.org.

Summer Art Camp for Ages 6-12

June 19-Aug. 10 Tues-Fri. 1-5pm. Creative workshops explore art-making in different forms, mediums, and environments.

Will include drawing, film making, textiles, mask making, theatre, dance, costumes, performance, and more.

\$40 a week per child/per day for 53204 residents; \$80 a week for WPCA members; \$125 non-members. MUST register wpca-milwaukee.org. Info: oscar@wpca-milwaukee.org or 672.2787

Milwaukee Art Museum

Free to all 1st Thursday of the month Apr. 5, May 3, June 7. 10am-8pm. Save \$19 (now the price of regular adult admission). Also free to Wisconsin K-12 teachers with valid school ID or pay stub. Regular admission: \$19 adult; ages 12 and under, free.

Family Sunday: By Land or By Sea 10am-4pm May 6

Come lakeside for a day of family fun. Explore landscapes, from the moody to the majestic, in *Coming Away: Winslow Homer and England*, and then mix your own paints to capture the beauty of Lake Michigan. Explore all the Kohl's Art Generation family programs.

Cost: Family Sundays are free for Boys & Girls Club members & their families with membership card or invite sheet. Also free to ages 12 & under, but must be accompanied by adult paying \$19 admission. May 6 is also "Member Swap Day," so free to those with an annual membership at Betty Brinn Children's Museum or other museums (see article on page 9).

Kohl's Art Generation Studio: open 10am-4pm Tues.-Sun., and 10am-7pm Thurs. Starting Memorial Day, also open 10am-4pm Mon. Stop by to create art inspired by artwork in the Museum. A different collection or exhibition is featured each month, and the activities are always changing.

Art Museum summer camp scholarships

Scholarships are available to cover the full cost of a camp- \$150 value! Classes for ages 6-10 at 10:30-12:30pm Mon-Thurs; ages 11-

15, 1:30- 4:30pm Mon-Thurs

June 18-21: Portraiture

June 25-28: Photographing Nature

July 9-12: Drawing in Motion

July 16-19: Painting: Beyond the Brush

July 23-26: Explore Printmaking

July 30-August 2: Creating with Clay

Info: 224-3803. Scholarship application: mam.org/learn/classes.php

What a deal! Annual family pass only \$20

Allows families that qualify to visit the Art Museum all year long, with free admission for two adults & children age 17 and under. Also, free admission to the popular MAM After Dark program (for adults). The Family Access Membership Program offers a family membership for only \$20 (normally \$95) to those who qualify for FoodShare, BadgerCare, Medicaid, or WIC. Sign up at the Museum's admissions desk or by mail. Proof of public assistance required. Info: 224-3284

Free Family Art Workshops

Fun and affordable visual art classes for families, toddlers, children, teens, and adults at Sharon Lynne Wilson Center for the Arts, 18905 W. Capitol, Brookfield, 53045.

PLUS - Free Family Art Workshops on 2nd Sat. of month 10am-noon Apr. 14, May 12, June 9. Each workshop features a different instructor and hands-on art project that the whole family can create together. All ages and skill levels are welcome. All supplies included.

Registration is required and workshops fill up quickly. Call 262-373-5023 or register online www.wilson-center.com/art-classes

Art program at the libraries

A drop-in program designed for children in Grades K5-5, although older siblings are welcome. Each visit begins with an A.W.E. artist reading aloud a story or two and then discussing the book or illustrator. Participants will then work on imaginative art activities relevant to the book or artistic theme for the day. Families are encouraged to attend and make art together!

Villard Square	Mondays, Mar 19, 26	5-6:30 pm
Mitchell Street	Wednesdays, Mar 21, 28	4-5:30 pm
Central	Saturdays, Mar 17, 24, 31	2-3:30 pm
East	Fridays, Mar 16, 23, Apr 6, 13	3:30-5 pm
MLK	Mondays, Apr 2, 9, 16, 23	4:30-6 pm
Capitol	Tuesdays, Apr 3, 10, 17, 24	5-6:30 pm
Center Street	Wednesdays, Apr 4, 11, 18, 25	4-5:30 pm
Tippecanoe	Tuesdays, May 1, 8, 15, 22	6-7:30 pm
Atkinson	Mondays, May 7, 14, 21, June 4	4-5:30 pm

Lynden Sculpture Garden: Art Drop-in

Noon-5pm Mar. 29. Ages 6 and up. \$16 (nonmember). Focus is on three-dimensional artmaking, but also can include painting, drawing and making collages. Separate group for age 11 & up. Register: 446-8794 or at www.lydensculpturegarden.org 2145 W Brown Deer

ReStore's 9th Annual Recycled Art Contest

Entries must primarily be made from donated product found at Re-Store. Repurposed items and art accepted. \$625 in ReStore gift certificates to be awarded as prizes. Entries due Apr. 7. 316-5621. See milwaukeehabitat.org/shop for info

Family nature fun

Havenwoods Environmental Awareness Center

6141 N Hopkins/1 block west of Sherman on Douglas/527-0232 All events are free. Hiking: come for a walk in the park anytime

Drop-Ins: nature activities, crafts, and games for families and youth groups, 9am-2pm Mar. 17: All Things Wet and Squishy; April 14 & 21: Animal Camouflage; May 12 & 19: Safety around Mosquitoes & Ticks; June 9 & 16: to be announced

Family Hikes: 10:30-11:30am. May 5: Bird Hike; June 2: TBA.

Family Night Hike: 6:30-7:30 pm. April 7: Nature at Night

Preschooler Storytime for ages 3-5 w/adult: 9:30-10:30am Mar. 27: Spring to Life; Apr 10: Boom! Bang! Thunder! Apr 24: Planet Earth; May 8: Opossums; May 22: Amazing Ants; June 5: TBA

Hiking: Come for your own walk in the park anytime. Visit the nature center 7:45 am-4:30 pm M-F and 9am-2 pm Saturdays.

Retzer Nature Center - Waukesha

S14 W28167 Madison St, Waukesha.

Register at waukeshacountyparks.com or 262-896-8007

Free events during Earth Week; must register ahead

Canoe Outing: adults & older children; Apr. 22; 1pm; register by Apr. 16; must provide own life jacket and canoe or kayak;

Raptors: adults & older children; Apr. 26; 6:30-7:30pm

Preschool Hike: April 26; 9-10am (ages 2-3); 1-2pm (ages 4-6); participants must be accompanied by an adult.

Earth Watch 5am-noon Apr 28; observe/record nature's sights sounds & smells; equipment provided; pick 1/2 hr. shift or more

Free Earth Week Finale – April 28

Planetarium Show: 8:30am-3:30pm; runs every half hour.

Family Bird Watch: 10-11:30am; meet at main entrance; learn do's & don'ts of birding; 1 hour hike in woods & open areas.

Family Activities & Crafts: 10-3pm

Master Gardener Station: 10-4pm; demonstrations on planting & garden options and answers to your questions.

Interactive Exhibits 10-4pm; activities and prizes for all ages; engage in new recycling, water resources, composing & more.

Trees & Wildflowers Hike: 2-3pm; meet at main entrance; guided tour through woods, prairie & trails.

Family Concert 3-5pm; **Campfire Songs & S'mores** 5-7pm

Magical Mystery Tour: approx. 7:15-9pm; guided twilight hike into Brown's Fen; very hilly terrain during darkness; bring your flashlight.

Regular Programming

Register ahead & dress for the weather for both programs.

Wee Wonders, ages 2-4 w/adult; 9:30-10:30am; **Apr. 10** Birdie Buffet; **May 8** Down in the Dirt; **June 12 & 13** Tadpole Tales.

Retzer Rangers, ages 5-7 w/adult, 4:30-5:30pm; arrive no later than 4:20pm. **April 9** Spring Fever: hike, then make a flower collage. **May 7** Down in the Dirt: explore, then plant something to take home. **June 11** Shaping Wisconsin: learn about glaciers that formed WI landscape & hike to search for these features.



Family yoga at Boerner in 2017

Boerner Botanical Gardens

9400 Boerner Drive Hales Corners. **Admission is free** on the first Tuesday of the month to Milw. County residents: May 1, June 5, etc
Spring Family Event: 10am-2pm Apr. 1. Come hang out with the Easter Bunny, enjoy kids' craft activities and egg hunts. Free.

Art at the Gardens Craft Fair 10am-3pm May 6

Mother's Day Family Event: 10am-2pm May 13. Kids' craft activities to create gifts for mothers and grandmothers. This & the Craft & Herb Fairs are free, but do not include admission to the Gardens

Herb Fair 9am-3pm May 19, free. Sponsor: Herb Society

Family Yoga in the Gardens 1-2pm May 20/June 24/July 22. \$5

Wehr Nature Center

Whitnall Park, 9701 W College Ave; \$3.50/day to park; phone # if need to register 425-8550. Natureonauts & Little Wonders programs are \$10 (if Milw. Co. resident); check date on Center's calendar.

Maple Sugar Days for Families: March 24 & 25; 1-4pm; \$6/person at door plus parking; children 2 & under free. Hikes begin at 1pm & continue every 15 min; walk to the sugarbush to visit an "old-time" sugarin' camp; boil-down demonstration & hands-on activities for children; taste a pancake with real maple syrup.

Pop-Up Nature Earth Day: 1-3pm April 22; \$5/family plus parking; ½ hour with naturalist followed by self-guided activities; games & crafts and scavenger hunt along Wehr's trails.

Frog Frolics: meet Wis. amphibians up close; stroll to the ponds & listen to the sounds of spring; register at least 2 days ahead. Either session is \$10/person plus parking (for Milw. Co. residents)

Adult Frog Frolic: April 27, 7-9 pm.

Family Frog Frolic: April 28; 7-9pm for ages 5 & up.

Reptile Day: June 10; 1-4pm; \$3/person plus parking; live snakes, turtles & lizards; meet a timber rattlesnake & ornate box turtle.

Spring Equinox, Welcoming Resurrection at Alice's Garden

Walk the labyrinth, explore the signs of new life, and reflect on what could be nourished and resurrected in your life this spring. 5-7pm March 20. 2136 N. 21 St.

Zoo discounts & special events

Regular Admission: Adults \$15.50; 3-12 \$12.50; 2 & under free. Parking is \$12.

Reduced admission on Weds. for Milw. Co. residents w/ID is \$9.25 adults and \$6.75 ages 3-12. Other days, Milw. Co. residents w/ID save \$1.75 off reg. admission. No discount on parking.

Above pricing starts Apr. 1. Thru Mar. 31, winter rates apply.

Special Events

Body Worlds - Animal Inside Out: special educational exhibit showcases 100 spectacular specimens, each preserved by the process of Plastination. now thru Apr. 15. Wed- Fri 9:30-2:30 & Sat-Sun 9:30-4:30. \$5.

Egg Day: Mar. 31, 9am-3pm; Easter Bunny, face painting, egg hunt; parade 2pm starting at Family Farm; free Carousel ride w/Woodman's receipt showing purchase of Nesquik product.

World Penguin Day: Apr. 21; learn about penguins.

Mother's Day: May 13: All mothers admitted free. Parking: \$12.

Party for the Planet: May 19 & 20; Eco-friendly family fun.

Dinosaurs! A Jurassic Journey: May 26-Sept. 3. Enjoy life-size dinosaur replicas while learning about dinosaurs. \$3.

Father's Day: Jun 17; All fathers admitted free. Parking: \$12.

Free Zoo Pass App with interactive map, fun facts about animals, dates & information about zoo events.

Hours thru May 25, 9-4:30pm; then 9-5pm thru Sept. 3; 256-5412



524 S. Layton. 257-5611
9am-5pm M-F; 9am-4pm
weekends/holidays
FREE on Mondays 9am-
noon to Milw. Co. residents

with ID (except holidays such as Memorial Day).

Regular admission: adults, \$8 (\$7 with Milw. Co. ID); ages 6-17, \$6 (\$5 for Milw. Co.). Ages 5 and under, free.

Railroad to Wonderland runs through Mar. 18. In an Alice in Wonderland theme, model trains run throughout the Show Dome. Four garden-scale trains travel on a fairy tale adventure through Wonderland, with giant mushrooms, miniature trees, a tea party and more.

Upcoming shows: *Shakespeare in Love* Spring Floral Show runs Mar. 31-May 28 and *To Bee or Not to Bee* opens June 2.

Special events: Spring Equinox Celebration, Sun, Mar 18, 9-4pm Guided tours, demonstrations, family-friendly activities, performances, live animals, organic gardening info, and a scavenger hunt. Learn about the equinox from Wehr Astronomical Society members and look through their telescopes at sunspots outside the entrance. Activities are free, but must pay regular Domes admission.

Very Fairy Princess Day, Sat, Apr 14, 9-4pm. Dress up as a princess, troll, wizard, or warrior and interact with other favorite well-known characters. Make a fairy garden for your own backyard, go on a scavenger hunt, or listen to fairy tales. Face painting, balloon twisting, and other surprises. Creating a fairy garden is \$10; other activities are free; must pay regular Domes admission.

Art in the Green: 9-5pm May 5; 9-4pm May 6.

Indoor art festival showcasing artwork of all kinds from local and regional artists in the Conservatory Annex, with food and entertainment throughout the Domes. Event is free, with regular Domes admission.



UWM Planetarium

See planetarium.uwm.edu to park. Physics Bldg 1900 E Kenwood.

Indigenous Voices: Sharing the Wisconsin Sky, 7pm & 8:15pm Fridays Mar. 23-May 4. Live presentation features the languages, star connections, traditional music, & cultural images from six Wisconsin Nations: Ho-Chunk, Menominee, Ojibwe, Oneida,

Potawatomi, and Stockbridge-Munsee. Suggested for ages 7 & up, and adults. \$5.

Music Under the Stars, 2pm Apr. 15. Live music from the Middle Ages and Renaissance on period instruments, accompanying a guided tour of spring stars and constellations. Adults and ages 5 & up. \$5.

Starry Safari: 2pm Apr. 21. The planetarium's first children's show will describe a night sky that's full of different animals that live around the constellations. Geared for ages 4-10, but open to all. \$5

Extreme Astronomy Cookout: noon-3pm, Apr. 28. Some of Milwaukee's most distinguished astrophysicists will discuss the universe's most bizarre and interesting features. Grab some food or catch a quick Planetarium show between lectures. Program is free; very reasonable cost for food.

Stargazing with telescopes Mar 23, Apr 13, 23, 27. 9:30-10:30 pm. View moon, planets, star clusters, and other astronomical objects from Physics Bldg. Skydeck If cloudy, Planetarium activity. Free.

Telescope observing sessions 8-10pm May 12 and June 9 on driveway at Wehr Nature Center, 9701 W. College. Cancelled if cloudy. Join members of the Wehr Astronomical Society for sky viewing.

Urban Ecology Center

UEC - Washington Park 1859 N. 40, 344-5460

Spring Break Nature Exploration Camp: 9:30am-3:30pm March 26-30. \$225 for the week, but scholarships are available. Visit www.urbanecologycenter.org to apply

Earth Day of Service, 9am-noon April 21. It's a working celebration of the Earth! Bring your friends and spend a morning helping in the park, followed by a free community lunch.

Zumba Fitness, 5:30-6:45pm every Tues. \$5 (nonmembers \$10) Dance to great music and burn a ton of calories without even realizing it with Zumba Fitness. Bring your dancing feet, gyrating hips and a desire to move! Classes open to all ages and skill levels.

Young Scientists Club activities range from hiking to helping with research to caring for the Center's animals. 4-6pm Tues-Fri., 1-4pm Sat, ages 5-12, \$10 annual membership.

Washington Park Library sessions: the Young Scientists Club also travels to the library Mar. 20, Apr. 13, Apr. 17. Join others there to explore topics related to science and make a craft. 4:30-5:30pm

Free fishing sessions on April 14 and June 2; equipment available, or bring your own.

Animal Feeding every Sat., 1-1:30pm. Free.

Other Urban Ecology sites

- Riverside Park, 964-8505

- Menomonee Valley, 431-2940

See: www.urbanecologycenter.org

Scholarships always available for program fees



Parenting groups, fun activities at family centers

The Parenting Network

For parent support and coaching or to register for all programs, call the Parent Helpline 671-0566. Ask about new additional programs. Also see website: www.theparentingnetwork.org

Welcome, Baby! The first years of your child's life are the most important. For expectant moms, caregivers and grandparents with children under age two. Provides weekly support, education and resources. One-on-one coaching addresses individual parenting concerns. Child care provided. FREE. Offered at two locations:

- At The Parenting Network, 7516 W Burleigh. 10-11:30am Thursdays, session runs through June 7. Registration is ongoing.

- At the Oak Creek Library, 10-11:30am Tues. runs thru Apr. 24.

Positive Parenting ongoing 10-week parenting class. \$30 fee. Child care provided. Offered 3 times each week:

- St. Josaphat Basilica, 6:30-8pm Thurs., 2322 S. 7 St.

- The Parenting Network, 6-7:30pm Wed. or 10-11:30am Tues. 7516 W. Burleigh.

Dads Matter 24/7 Every child has a place inside that only a dad can fill. Ongoing 10-session series, 10-11:45am Sat, 7516 W Burleigh. \$30. No child care available.

Parent Cafe's: Be a voice in your community; share your wisdom; learn from others; enjoy peer-to-peer support; and act together to create change. Free. Register for free childcare. Offered in the Muskego Way area, 2nd Tuesday of the month; Metcalfe Park, 3rd Tues.; and Harambee (days vary). Info: Eyleen Lopez, 671-5575 x28.

Stewards of Children: Workshop provides you with the tools to help prevent the sexual abuse of children. Free to parents; no child care. 9:30-noon Mar. 29, Apr. 11, or June 6; 6-8:30pm May 1 at The Parenting Network. Call to register: 671-0566.

The Triple P Group: This 8-week class provides practical strategies for behavior problems using the Triple P method. To learn more, call the Parent Helpline, 671-0566. No child care. \$30 fee.

Triple P Seminars/Discussion Groups See dates, sites on p. 17.

Triple P One-on-One Coaching: Looking for parent support to deal with a specific behavior challenge? Meet with a Triple P accredited coach to get the problem under control. Call for an appointment at a location near you: 671-0566. For parents of ages 2-12. Free.

START (Sex Talk as Real Talk): Info and resources that will support you in conveying *your* values and expectations about sexual behavior to your children. Call for times and locations. Free.

Bay View Community Center

1320 E. Oklahoma. Other programs include drop-in playgroups Mon-Sat., exercise or music with baby, and more: www.bayviewcenter.org Register at least 1 week ahead of classes: 482-1000:

Make & Take Spring Craft, 10-10:45am Mar. 24, for parents with children 18 mos. and up. \$5. **Mother's Day Surprise make a craft./gift** 10-10:45am May 11, for parents w/children ages 2-6, \$5

Family Fun Night: *Around the World* theme, 6-7:30pm Apr. 12, for families with children 2-10 yrs. Food, art, and cultural activities from other countries. \$10/family

Pre-school Playhouse for ages 3-5 yrs., 10-11:30pm Tues. Apr. 10-May 15. \$36 for series.

Grandparenting with Love & Logic, 6-8pm Apr. 17. \$10

Preschool Mini Adventures (ages 3-6): Camping Out Day, 10-11:30pm Mar. 27; Dinosaur Dig 10-11:30pm April 3. \$10 each day.

COA Youth & Family Centers

- *Samson Family Resource Center*, Riverwest Center, 909 E Garfield. Contact Center at 290-7908 with any questions about:

Family Drop in Program 9:30-11:30am Mon-Friday. A warm and welcoming place for parents and their young children to socialize with other families, positively interact through art, free play, a nutritious snack, & song circles. Parents may receive resources, including clothing, diapers, food, and referrals for housing and employment.

Lunch Bunch: 11:30-1pm Mon.-Thurs; bring your own lunch, eat with other families, play afterwards.

Family Camp: those enrolled in the Family Resource Center may attend the upcoming camp session in Almond, WI for free. Call Program Coordinator about becoming a Center participant.

Baby Box Distributor: free safe sleeping spaces for babies.

Zumba: Thursday nights, 5:30pm

- *Gill Family Resource Center*, Goldin Center 2320 W. Burleigh Contact Resource Center at 265-7689 with any questions about:

Goldin Gatherings Tues. 5-6pm "How to Live Free" workshop series. Come and enjoy learning ways on how to live your life in a state of "freedom." Through interactive and organic discussion and activities. Learn about strategies that will strengthen individual and family lives. Light refreshments and childcare available.

Keeping It Real workshop series 5-7pm Thursdays starting Mar. 22. Come and enjoy learning ways on how to deal with life-changing events through organic discussion and activities. Learn about strategies and resources that will strengthen an individual's way to cope and deal with different situations that happen in everyday life. Light refreshments and childcare provided.

Family Camp: those enrolled in the Family Resource Center may attend the upcoming camp session in Almond, WI for free. Call Program Coordinator about becoming a Center participant.

Professional Development 10am-noon Mon. & Thurs. Help with resumes, cover letters, finding employment, other community needs

Goldin Girls: group for elders 55+ has field trips, lunches, gardening, arts and crafts, sewing & quilting. 9am-12:30pm Tues. & Fri.

Baby Box Distributor:

Zumba: Wednesday nights, 5:30pm

Do you have children's books to donate?

We provide new and used children's books to our community partner, the Christ Child Society, which runs Second Saturday, a monthly gathering where reading is stressed and books are distributed to each family. Book donations can be dropped off at the HOPE Network office, Room 201 on the second floor at Good Shepherd, N88 W17658 Christman Rd., Meno. Falls. If the office is closed, books may be left outside the door. If you do a book drive at your workplace or organization, you may call to have the books picked up: 262-251-7333

Heavy fabric needed

HOPE Network needs donations of home decor fabric. It should be at least a yard or more. The sturdy fabric is used by our volunteer who sews the tote bags that are used for our layettes of new infant supplies. Fabric may be dropped off at the HOPE Network office or left outside our door (see above).



Mom and baby at a gathering of the African American Breastfeeding Network

Held twice a month. Pregnant women, breastfeeding moms, and their families attend for support, education, networking, and encouragement.

Breastfeeding resources

African American Breastfeeding Network Breastfeeding Community Gatherings for pregnant or breastfeeding mothers & families. Dads encouraged to attend, discussion led by male leader. 617-3441

Program and dinner every second Thursday of the month at Northside YMCA 1350 W. North: 5:30pm.

Program every 3rd Sat. at Parklawn YMCA, 4340 N. 46. 11:30am, includes lunch.

- **Columbia St. Mary: Breastfeeding Getting Ready** 6-8:30pm Wed. Apr 11, May 9, June 13. \$20 (scholarships available). Attend while pregnant. *Working Women & Breastfeeding* 1:30-3pm Wed. Mar 28, Apr 25, May 30. \$15. 2323 N. Lake Dr. Register: **585-1025**. If not sure baby is getting enough milk or if mom is in pain call 291-1440 ASAP; don't wait for class.
- **St. Joseph Hospital Breastfeeding with Confidence** 6-8:30pm Mon. Mar 26, Apr 9, May 14, June 11. Best if attend at 7th/8th mo. \$20 fee waived for WIC moms. Register online. Info: 477-2622 Classes also at Elmbrook Hospital, Brookfield.
- **16th St. Community Health Center** at 1032 Cesar Chavez Dr. Every Thurs. breastfeeding class 11am-noon & prenatal class 5-7pm Both in Spanish. To request set-up for English, call 897-5289
- **Mothering the Mother, Inc** Free drop-in breastfeeding help Weds. 9-11am 1st come/1st served. Breastfeeding class: 6-9:30pm Mar. 20, Apr 24, May 23. \$40; scholarship available. La Leche League 11am-12:30pm 1st & 3rd Wed. 1588 S. 81st St., West Allis. Info: 262-617-7461. www.motheringthemothertinc.org
- **Breastfeeding groups** Waukesha Hosp. 1-3pm Wed; Oconomowoc Hospital 1-3pm Thurs Breastfeeding helpline: 262-928-7650
- **Waukesha:** Breastfeeding class 12:30-2:30pm Apr 24. Also in Spanish. Register, Waukesha Co. Public Health: 262-896-8362.

Free training for breastfeeding counselors

Outpatient breastfeeding supporters can receive free "Breastfeeding Champion Training" April 19-20. It's presented by the African American Breastfeeding Network (AABN) and the Wis. Assn of Lactation Consultants. The 16-hour training is free; however, attendees must receive a pass-code for free enrollment. To request the code and to learn more about this course, contact Dalvery Blackwell, AABN exec. dir. aabn@ymail.com or themilkmob.org/milwaukee2018

Parent Peer Support Group for parents of youth or adolescents with disabilities

6-7:30pm on last Tues. of mo. (eg: Mar 27, Apr. 24, May 29) IndependenceFirst wants to connect with non-judgmental parents of individuals with disabilities who share similar experiences. Parents share strategies to cope with difficult situations, provide informational resources, and offer encouragement during both challenging and rewarding times. To RSVP or to request accommodations, contact Harvey at 226-8127 V/Relay or Tonya at 226-8138 V/Relay. IndependenceFirst, 540 S. 1st St. Free.

Our Daily Bread Community Outreach Center

6040 W Lisbon #203, 301-3732. *Prenatal/new moms p. 18-19*

5th Annual Mommy & Baby Community Resource Fair, noon-3pm May 5, Villard Street Library, 5190 N. 35 St. Information about resources for mothers and families. Vendors include HOPE Network, Milwaukee Birthright, Carenet, New Plan, New Life, and more. Door prizes, raffles, gifts, and light snacks and refreshments will be served. For more information, call 301-3732

A Better Us Support Group for pregnant women or mothers with children. Includes candid discussion on AODA challenges/mental illness. Participants will receive community referrals and other assistance to help combat ongoing challenges. Light refreshments.

6pm-6:45pm every 2nd & 4th Monday of each month. Must sign in by 5:45pm to be eligible for free diapers. 6040 W. Lisbon Ave, Suite #203. For more information, call 301-3732

Mommy and Me Expo

New Hope Youth and Family Services will be having their second annual Mommy and Me Expo on May 19 at the Zoofari Conference Center in Wauwatosa. Kids' Zone, fashion show, vendors, workshops. Advanced tickets are \$7. Kids 12 and under free. Tickets can be purchased through Eventbrite. 758-3631

Project Hope Youth Program

7113 W Capitol 342-1303
Tues: Art Saves Lives 5-6pm Boys Mentoring 6-7:30pm
Wed: Teen Job Prep 5-6:30pm Girl Power Mentoring 6-8pm

Infant CPR classes at Columbia-St. Mary's Hospital 9-10:30am Sat. Apr 28, May 5, June 16 or 11:30-1pm May 5. \$30. Must register: 585-1025 or babyclasses@columbia-stmarys.org



Babies are safest when they sleep alone, on their backs, and in a crib free of blankets, pillows, or toys. Home should be smokefree. Exposure to smoke raises risk of sleep-related deaths.

If you are in need of a safe place for your baby to sleep, contact the Milwaukee Health Department, 286-8620, or HOPE Network.

Neighborhood House

2819 W. Richardson Place, off 27th St., one block south of W. State
Head Start on p. 20

Spring Yoga Series: 6-7pm Mon., Apr. 2-May 7; \$5; more on p 4
Earth Day Celebration, April 14, 12-2:30pm. Celebrate the diversity of our earth and learn how to be a better guardian of the planet. Hands-on activities will include music, food, and garden demos.

Get Yourself Tested, April 14, 11:30am-2:30pm Free STI & HIV testing. Become a better advocate for your health by attending workshops provided by PATCH teens. Food and door prizes.

Earth Day Clean-Up, Apr 21, 9am-noon Help take care of Mother Earth by participating in the Historic Concordia Spring Clean-up. Group meets at Neighborhood House. Register: 933-6161 ext. 142

Tobacco Prevention Walk, May 19, 11am-1:30pm. Rally against tobacco use! Walk begins and ends at Neighborhood House Garden Park, corner of 27th St. and Richardson Pl. Games and food follow.

Neighborhood House Skate Night: Friday May 18 from 6-8pm Free to attend with the donation of 2 non-perishable food items.

Free Family Adventures

All leave from Neighborhood House, 2819 W. Richardson Place. Pack a lunch for each field trip. Register: 933-6161 ext. 142.

Maple Sugaring, March 17, 9:30am-1:45pm Help make syrup at 93-acre Nature Center in Dodge County. Bus departs NH at 9:30am.

International Crane Foundation, April 28, 9:30am-6pm. View all 15 of the world's crane species. Also, learn how to make an origami crane. Bus departs from NH 9:30am.

Kohler Arts Center, May 12th, 9:45am-4:30pm Enjoy a guided tour at the Kohler Arts Center, followed by a hike at Kohler-Andrae State Park. Children ages 5+ welcome. Bus departs NH at 9:45am.

Overnight Camping Trip, June 2-3. Spend a great weekend in the outdoors with this free overnight camping trip at their 93-acre Nature Center. Van leaves from NH at 9am on Saturday and returns at 1pm on Sunday. Meals and camping supplies will be provided. Families must register to attend; contact Amy, 933-6161 ext. 173



Positive Parenting Programs

Receive parenting support at a free guided discussion group provided by The Parenting Network. Learn strategies that really work!

Central Library: *Hassle-free Shopping with Children* 9:30-11am Apr 13.

Free. Register: 286-3011 or www.mpl.org

Sojourner Family Peace Center: *Dealing with Disobedience.* 10:30am-12:30pm Mar. 20. Free. Register: Colleen, 810-1525.

Oak Creek Library, 6-7:45pm Tues. Register oakcreeklibrary.org
Mar. 27: *Hassle-free Shopping with Children*; Apr. 10: *Developing Good Bedtime Routines*; Apr. 24: *Raising Resilient Children*. Free.

Franklin Library, register: Franklin Health Dept 425-9101. Free.
6:15-8pm Mar. 29: *Developing Good Bedtime Routines*; Apr. 3: *The Power of Positive Parenting*; Apr. 10: *Dealing with Disobedience*

West Allis/West Milwaukee Rec. Dept. \$6/resident; 6:30-8:15pm
Apr 4: *Raising Resilient Children*. Register www.wawmrec.com

MPS Recreation Dept, Beulah Brinton, 2555 S Bay: \$7/resident;
6:30-8pm Apr 25: *Developing Good Bedtime Routines*; Apr 30: *Dealing with Disobedience*. Register: www.MilwaukeeRecreation.net



Strong Baby Sanctuary

Are you pregnant or have you recently given birth? Contact a Strong Baby Sanctuary to learn about community resources to support you and your family. The Strong Baby Sanctuaries embrace pregnant women and their families and offer information and resources, mentorship and spiritual support to create stronger babies in the Milwaukee community.

For information or to schedule an appointment, please call:

- Ascension Fellowship Church,
4925 N. 24 Place, 378-4031

- Bethel CME Church, 3281 N. 26 St., 315-0272
- Bethel Temple Church of God in Christ, 2576 N. 5 St., 397-5833
- Bountiful Harvest Church of God, 3300 N. 39 St., 871-3881
- Bradford Memorial AME Church, 4260 N. Teutonia, 445-2189
- Calvary Baptist Church, 2959 N. Teutonia, 372-1450
- Canaan Baptist Church, 2964 N. 11, 264-2070
- Capuchin Community Services/House of Peace, 1702 W. Walnut, 933-1300 ext. 11
- Christ Mission CME Church, 1601 W. Clarke St., 264-3515
- Catholic churches/eastside/St Hedwig 1716 N Humboldt 271-6577
- Divine Temple C.O.T.F.B., 5532 W. Hampton, 617-3300
- Ebenezer Church of God in Christ, 3132 N. King Dr., 793-0328
- For Him International Ministries, 2544 N. 27 St., 263-8960
- God's Hands Outreach Ministry, 6151 N. Sherman, 687-1888
- Greater Bethlehem Temple World Ministries, 222 E. Center St., 264-5350
- Hephatha Lutheran Church, 1720 W. Locust, 264-0238
- Holy Cathedral Church of God in Christ, 2677 N. 40, 447-1965
- Lamb of God Missionary Baptist Church 8415 W Bradley 355-0931
- Little Community C.O.G.I.C., 2025 W. Hampton, 514-5151
- Mount Calvary Lutheran Church, 2862 N. 53 St., 873-3931
- Mt. Zion Missionary Baptist Church, 2207 N. 2, 372-7811
- Newport Missionary Baptist Church, 2237 N. 11 St., 265-5881
- Pilgrim Rest Baptist Church, 3456 N. 38 St., 873-1045
- Reformation Lutheran Church, 3910 W. Lisbon, 444-0440
- Silver Spring Neighborhood Center, 5460 N. 64, 463-7950 ext. 70
- St. John Concordia CME Church, 300 W. Concordia, 264-9881
- St. Martin de Porres Catholic Church, 128 W. Burleigh, 372-3090
- St. Matthew CME Church, 2944 N. 9 St., 213-5091
- True Love Missionary Baptist Church, 210 W. Keefe, 264-6869
- Unity Gospel House of Prayer Apostolic Church, 1747 N. 12 St. 574-1245
- Unity Lutheran Church, 1025 E. Oklahoma Ave., 744-6311
- Village Ministries Inc., 2614 W. Center, 535-8227

Consider joining the Sanctuary program

The Strong Baby Sanctuary program has an important goal: To assist faith communities in being a safe place for pregnant women as well as new mothers, fathers and families to get health-related support. Consider joining the program in the important work to ensure that more Milwaukee babies are born strong and can thrive through their first year of life. Contact Penelope Stewart, 585-4805.

Local resources help you be a better parent

PREGNANCY –

Counseling and prenatal care

City of Milw. Health Dept. home visits: offers several nurse home visit programs for parents-to-be who are City of Milwaukee residents. Call 286-8620 to speak with a nurse.

Waukesha: Childbirth education classes Mar 27, Apr 10, 17, 24. 12:30-2:30pm Free. Participant receives free baby gift after each class attended. 514 Riverview Ave. Register: 262-896-8479

UWM Community Nursing Center Prenatal care coordination services provided at our sites: House of Peace, 1702 W. Walnut, call 933-1590; and Silver Spring Neighborhood Center, 5460 N. 64, call 535-0432 (family planning services only provided at this site). Call for info or to schedule at appointment.

Next Door Head Start and Early Head Start home visitation provides weekly home visits for pregnant moms & families with children up to 5 yrs. Services available for special needs children. 2545 N. 29 St. & 5310 W. Capitol 562-2929 ext. 2541

16th St. Community Health Center At 1032 Cesar Chavez Dr: Every Tues. car seat class English/Spanish 10-11am
At 2906 S. 20 St: Prenatal Class - call for dates: 897-5296

Welcome, Baby! for expectant moms, caregivers & grandparents with children under age 2. 10-11:30am Thurs. thru June 7 at The Parenting Network, 7516 W. Burleigh, and 10-11:30am Tues. thru Apr 24 at the Oak Creek Library. Info at TPN: 671-0566.

Mommy & Baby-Live Well Be Well supports expectant mothers & mothers with newborns (30 days or less). AODA/mental health assistance, parenting classes, nutrition education, community activities, breastfeeding training, lifestyle management (stress relief techniques) clothing incentives, and \$25 client referral program.. Baby Boxes (safe sleeping space) available. 301-3732. Our Daily Bread Comm. Outreach Center, 6040 W Lisbon, #203

Life Enhancement Supportive Services: prenatal care coordination, childcare coordination, AODA/mental health services for eligible women. Continues to help mothers with access to medical, social, and educational resources until the child's 7th birthday. 6001 W. Center St. Ste. 100, 444-2380

Encompass Solutions: free prenatal care coordination PNCC/CCC for expectant mothers receiving Medicaid/BadgerCare benefits. Services: parenting, nutrition & childbirth education, employment training, housing resources & baby items. Info: 722-3274

Kingly Community Resource Center provides information, resources and support to pregnant women & mothers of newborns (2 mos. or younger) who receive Medicaid/BadgerCare. Referrals given to financial resources, quality healthcare, quality childcare, computer lab, resume prep, and parenting classes. 4200 N Holton St Ste. 110. Contact: Ms. Torrie Moffett, 933-6768

Mothering the Mother Birth professionals Meet & Greet (call for date/time). PNCC services to those who qualify; childbirth & breastfeeding education & support groups. www.motheringthemootherinc.org. 1588 S. 81 St, West Allis. 262-617-7461

Prepared Childbirth classes at Columbia-St. Mary's Hospital See listings at www.columbia-stmarys.org. \$80, but partial or full scholarships available. Must register. 2323 N Lake Dr. 585-1025

Childbirth Preparation series at Wheaton Franciscan hospitals: St Joseph Hospital, St. Francis Hospital, and Elmbrook are listed at: www.mywheaton.org \$80 fee waived for WIC moms. Call 447-2622 for more information

Childbirth education at Aurora Sinai: see Teen Services p. 19

Inner Peace Doula Services provides birth and postpartum doula services along with non-judgmental support, resources. Will work with you on various payment options. Contact Tonia, 915-0308 or Innerpeacedoulas@gmail.com to set up free consultation

Well-Rounded Maternity Center: Babywearing 1-2:30pm 4th Sat; Cloth Diapering 2:30-4pm 2nd/4th Sat. \$15 each. Resale of maternity clothes & cloth diapers. Birth Options Seminar 1st Tues. 7-9pm \$5. New Parenting Circle/support group 11:30am-1:30pm Fri. \$5 donation. 2455 S Howell, Bay View. 744-7001
<http://well-roundedmaternity.com/>

Prenatal care coordination from health insurance companies includes help to find baby supplies, local resources, childcare, and provide info on nutrition, breastfeeding, parenting:

Managed Health Services Start Smart: 1-800-496-5803. Includes free home visits from nurse or social worker.

If you have *Dean Health Plan*, call 608-830-5908 re: the Strong Beginnings program

UnitedHealthcare 1-800-599-5985 free to anyone with Medicaid. Provides ongoing prenatal support over phone re: Healthy 1st Steps

Healthy Mom, Healthy Baby Prenatal care coordination program free to *Children's Community Health Plan* members (HMO for families w/Badger Care Plus). Get support & services needed to have a healthy pregnancy, healthy baby. Incentive program to earn baby items & gift cards, welcome mom kit, breastfeeding kit, home visits. 266-3751

iCare for Mom and Baby: free prenatal program for pregnant *iCare* BadgerCare Plus and Medicaid SSI members. Help to find a health care provider and obtain baby supplies. Independent Care Health Plan (*iCare*): 1-800-777-4376.

Care Net Pregnancy Center of Milwaukee 10am-4 pm Mon-Fri Pregnancy tests, ultrasounds, free prenatal vitamins, maternity clothing, baby clothing, diapers & items. Post abortion support & options counseling. Call for an appointment. Free, confidential. 2917 N Oakland. 962-2212

Pregnancy counseling & resources & Family Resource Center: Children's Hospital. 453-1400.

Coalition for Children Youth & Families provides information to those thinking about adoption for their child and to prospective adoptive parents, professionals & others interested in adoption information. www.wiadopt.org 1-800-762-8063

Lutheran Counseling & Family Services adoption, birth parent counseling, resources, and education services. 3800 N Mayfair Rd. 536-8333

Milwaukee Birthright, free pregnancy tests, physician referral, call before coming. Layettes given 3-4 wks before due date; bring photo ID, and pregnancy statement. 2025 W. Oklahoma Suite 125 672-5433 (24 hr. line)

New Beginnings long-term program w/ housing that guides new, single mothers towards self-sufficiency with opportunities to continue education, grow spiritually, learn parenting skills. 376-0595

Women's Support Center: 100% free services. Pregnancy tests, ultrasounds, breastfeeding & childcare classes, fertility care, material assistance for mothers with babies & small children, and natural family planning. 2051 W. Wisconsin Ave. 934-8888

Women's Care Center, free pregnancy test, free limited Ob/ultrasound (appointments required), medical & social service referrals, childbirth & parenting classes, material assistance when enrolled in Center services. 634 W Historic Mitchell St 645-4050, bilingual. 1441 N Farwell. 223-2610

Associated Pregnancy Services unintended pregnancy consultation, free pregnancy tests, limited ultrasounds. Loving Parents Incentive Program, newborn gift pack, diapers, post-abortion support. 8501 W Lincoln, 1214 S. 8th St.. Call helpline for walk-in hrs or for appointment: 727-8177.

Adoption Choice, Inc: Confidential, supportive and caring private agency offering free pregnancy counseling, emotional support & adoption support services. Education, resources, home visits. 500 W. Silver Spring, Ste. K235. 24 hr hotline: (800) 255-6305

Pregnancy/Parenting Hot Line confidential line for Waukesha & Milw. Co. Pregnancy & parenting info, referrals for insurance, doctors, WIC, housing, etc. 8am-4pm M-F 262-548-4000

A Place of Refuge: 476-6333. Volunteers offer support and help to provide resources for pregnant women. A shelter, where women and children can stay throughout the pregnancy, is also available.

Catholic Charities Pregnancy Support Program assists expectant mothers and new mothers with emotional support, community resources, education for pregnancy and parenting. Also works with parent wanting to make an adoption plan. Home visits available. Free. 2021 N. 60. 771-2881

Pregnancy Support Services of ECFA pregnancy counseling support & goal setting, home visits, Baby Boxes available for clients (safe sleeping space), parenting support, adoption services, short-term newborn respite care, home visits. Free and confidential. Evangelical Child & Family Agency, 1617 S. 124. 262-789-1881 24-hr. emergency line

Bethany Christian Services free pregnancy counseling, information on all options, confidential support, adoption & voluntary foster care services, parenting resources. N14W23755 Stone Ridge Dr Waukesha. In-home visit if have no car/Wendy: 262-547-6557

Waukesha/ Tomorrow's Choice Family Resource Center Mon 4-7pm, Wed & Sat. 9-noon Free, confidential counseling re: pregnancy & post-abortion stress related issues. Baby supplies are also distributed (diapers: size NB-5, wipes, clothing up to 24 mos.) Not a medical facility. 912 N Barstow, Waukesha, 262-513-9590

Easter Seals, Safe Babies Healthy Families pregnancy & parenting home visits for Waukesha and Milwaukee Counties (plus some areas of Walworth Co.) Education, support, resources, adoption information. English/Spanish mom's groups. Baby Buddies, Childbirth education class in Milw Co. 262-548-4000

BREASTFEEDING resources moved to p. 16

BABIES and CHILDREN

Welcome, Baby! for expectant moms, caregivers & grandparents with children under age 2. 10-11:30am Thurs. through June 7 at

The Parenting Network, 7516 W. Burleigh. and 10-11:30am Tues. thru April 24 at the Oak Creek Library. Info at TPN: 671-0566

Mommy & Baby Live Well Be Well Care coordination (CCC) for mothers with newborns (30 days or less). Continued CCC services until child is age 7 (access to AODA/mental health, educational, & social resources) at Our Daily Bread Community Outreach Center, 6040 W Lisbon #203, 301-3732

Mommy & Baby Project: free emergency diapers, by appt. only. Call 755-0535 w/ your name and phone no. & call will be returned in 24-48 hrs. Please speak clearly.

Also see: **A Better Us-Support Group For Mothers and Mommy and Baby Community Resources Fair** on p. 16.

My Morning with Mom 10-11:30am Thurs mothers & babies, discussion with health care professional. Aurora Women's Pavilion 8901 W. Lincoln. Info: 888-863-5502

New Parents Network Newborns & infants 11am-1pm Wed. Toddlers 8:30-10:45am Wed. Columbia St. Mary's Hospital.

Moms Chat 10-11:30am Tues. Wheaton Franciscan Brown Deer Campus (inside Y) 9252 N. Green Bay Rd. 447-2622. Registration is not required.

Infant Massage Sat 10:30-noon Mar 24, Apr 28, May 29; 1:30-4pm Mar 21, Apr 28, May 23, bring baby 4 wks to pre-walker. \$15, but can ask for scholarship. Columbia St Mary, 2323 N. Lake Dr. 585-1025

Mothering the Mother Baby Wearing & Cloth Diapering on a Budget, both \$10, motheringthemothertinc.org 262-617-7461

Women's Care Center Crib Club coupon incentives if enrolled in class for crib, car seat, stroller, clothing, diapers. Classes: one-on-one birth preparation, baby care basics, breastfeeding, & goals 634 W Mitchell St, 645-4050/1441 N Farwell 223-2610

New Concepts 8-wk parent series Wed 10-noon or Th 5-7 pm Register 1st day; only 30 in class. 1531 W Vliet 344-5788 x30

Children's Hospital adoption services, child & family counseling, foster care, parenting programs 620 S 76, Ste 120. 453-1400

Baby Connection 10:30-noon Wed. Free mom's support group at Elmbrook Memorial Hospital, the Pavlic Center, 1933 W. North Ave. Brookfield, 447-2622

Safe Families for Children Provides a secure, temporary home for children whose parents are in a crisis situation. May provide housing assistance to teen moms and their children. Families in need may also be connected to Family Friends and Family Coaches. Info: 405-9318. For immediate placement: 24-hr line: 855-240-6604

Teen parent services

Childbirth education free classes (**Easter Seals Safe Babies Healthy Families**) **Aurora Sinai**, 960 N. 12, 4:30-6:30pm 4 Thurs starting Apr. 5 and May 24. Receive diapers by attending all 4 classes Register: 262-548-4000

Are you pregnant, just had a baby or have children under 5?

WIC provides food, as well as nutrition information, to help keep families healthy. At Northwest Health Center, 7630 W Mill Rd.; Keenan Health Center, 3200 N 36th St; Southside Health Center, 1639 S 23rd St. Call 286-8820 to make an appointment.

Classes for childcare providers, budgeting, home buyers

Ready to Read with Books2Go

FREE childcare provider continuing education by Milw. Public Library. Registration required, begins 1 month ahead. Register early; classes fill up fast: call 286-3011 or register online at www.mpl.org/childcareworkshops. Adults only; no children. All Tier 2.

Six Skills for Early Literacy: Leave with fun ways to expand lessons with books to include the skills. This workshop is the foundation for other provider workshops, and we recommend you attend this first. CE: 3.0 hrs. Villard Square, Mar. 24, 10:30am-1:30pm.

Start Right, Finish Bright: Building Foundations in Your Infant & Toddler Classroom Learn to create an optimal environment for healthy brain development in babies & toddlers. Leave with a list of great books and activities that promote early literacy skills. CE: 3.0 hrs. Washington Park 10:30-1:30pm Apr 14

Let's Give Them Something to Talk About: Developing Narrative Skills in Children (the ability to tell stories and describe things). Learn the importance of narrative skills & explore books that help develop this skill. CE: 2.0 hours Capitol, Apr 21, 10:30-12:30pm

Free Head Start for infants & toddlers

- **Milwaukee Public Schools** Free preschool for low-income children ages 3 & 4. Families supported with services in education, health, dental care, mental health, and disabilities. Children with special needs are an enrollment priority; those in foster/kinship care are automatically accepted. 26 sites with half-day K3, full day K3, or full-day K4. Free transportation. Info/registration: 252-0350

- **Neighborhood House** has full day, full year Early Head Start program. Ages 6 weeks to 3 years. Special needs children welcome. Diapers provided in class. 2819 W Richardson Place. 933-6161 ext 139

- **Acelero Learning Wisconsin** is still enrolling children ages 3-5 for the 2017-2018 school year. Acelero has 10 locations throughout Milwaukee Co., including 2 new K4 locations in Cudahy. You can find all of their centers at www.acelero.net Acelero has more Five Star centers in SE Wis. than any other program. To enroll, call 616-5000

- **Next Door Head Start** for ages 3-5. Nutritious meals, field trips, family resources/referrals, results-based curriculum. Must meet income guidelines. Sites throughout Milw.; main campus, 2545 N. 29. Info: 562-2929 ext. 197. Early Head Start home visitation & PNCC/CCC programs provide weekly home visits for pregnant moms & families with children up to 3 yrs. Services for special needs children. 2545 N 29 & 5310 W Capitol 562-2929 x 290

Fresh Picks Mobile Market: A grocery store on wheels. Provides healthier food choices than convenience stores. Along with other staples, the Mobile Market offers seasonal fruits, vegetables and high demand meat and dairy items. Accepts debit cards, credit cards and Quest EBT (not cash). See Milw. County schedule at: www.picknsave.com/mobilemarket or call 2-1-1.

Questions about getting a license or permit for business?

City of Milw. Pivot Program will explain rules and regulations & help resolve problems. For prospective or existing hospitality businesses. 9-11am Water Tower Bldg, 4001 S. 6 St. (3rd floor). Register by sending your name & business name to pivot@milwaukee.gov

Homeownership Fair 9am-noon Mar 24 Journey House 2110 W Scott. Homebuyers & homeowners can connect with lenders, realtors, & homeownership specialists to learn about buying, fixing, or keeping a home. 9:30am home rehab workshop. Home tours at 10:30am (Clarke Square area) and noon (KK River neighborhood). Free. TakeRootMilwaukee.com

Home buyer workshops - Free

Housing Resources, Inc., a HUD-approved organization, offers workshops for homebuyers or homeowners (below). For more information, call 262-622-1230 or visit www.hri-wi.org

Homeworks Workshops for first-time homebuyers. Real estate experts help buyers avoid common pitfalls when buying homes. Learn to improve credit, maintain savings, and budget. Hear about grants to help with down payment and closing costs.

-- 6-8:30pm March 21 & 28; April 11, 18 & 25; or May 16, 23 & 30 Central Library,

-- 10-4pm March 24 or May 19 at Light House Youth Center

-- 10-4pm April 28 or June 9 at Journey House

-- 9am-noon Apr 3/10 or May 1/8 at Mary Ryan Boys & Girls Club

-- 9am-noon June 5/12 at SDC. For Waukesha dates: see p. 6.

"I bought a house! Now What?" workshops: maintenance basics, home retention tips, how to get involved in the community, and learn how to qualify for local home improvement resources or tax foreclosure prevention resources. 9am-noon Apr 7 & 14, May 5 & 12 or June 9 & 16 at Housing Resources' Office.

Homebuyers Seminars United Community Center. Learn the process of buying, get pre-qualified for a mortgage, loan, homebuyer certificate, learn about grants. 6-10pm

English Part 1: Apr. 5, May 3, June 7. *English Part 2:* Apr. 12, May 10, June 14. *Spanish Part 1:* Mar. 22, Apr. 19, May 24.

Spanish Part 2: Mar. 29, Apr. 26, May 31. 1028. S 9, 384-3100

First Time Home Buyer free seminar 6:30-8pm March 20 and April 17, UW Credit Union. 2525 S. 108 St. Topics: Is buying a home right for you? The process of buying a home. Different loan options. How to get pre-approved so you can start looking for a home in your price range. Register: www.uwcu.org Select tab: Advice & Planning, then: "Financial Education."

Home Buying seminar 6-7p Apr 18 Washington Park library

Prepare for a culinary career: ProStart

Culinary Arts Hospitality Job Training by SDC, 1730 W. North, & HeartLove Place, 1927 N. 4. Must be Milw. Co. resident, 18 or older. The next course will run May 7-Aug. 10. Check with HeartLove Place for the dates of the orientation sessions: 372-1550, x120.

Absolute Advantage Construction Job Training

begin a career in a well-paying industry 9-week training starts May 16 at SDC, 1730 W. North Ave. Introduction to construction math, and tools, power tools, construction drawings, basic rigging for income-eligible applicants. Learn about careers such as carpentry, concrete finishing, electrical, heating, plumbing, roofing, and more. Mandatory info session at SDC: 12:30-1:30pm May 8 or 4:30-5:30pm May 10. Register online: cr-sdc.org or call 906-2711. Free

Computer help

Milw. Public Libraries: free 2-hr. hands-on computer training; register at www.mpl.org or 286-3011. Walk-ins welcome if space is available. Computer basics, Internet, e-mail, beginner & intermediate Word, PowerPoint, Excel Day, evening, and Sat. a.m. sessions.



Journey House computer class

1-2:30pm Tues. & Thurs. New class starts each month, although students may continue. Bilingual. Free onsite childcare, ages 1-6. 2110 W. Scott. Call for cost/ to register: 647-0548

Free adult education

Offered by Literacy Services of Wisconsin thru MPS. GED prep, GED in Spanish (at South Division only), HSED alternative (at North Division only), reading, writing, math, English language learning (ELL), citizenship, basic computer skills, resume preparation, skills for helping children with homework and more are offered one-on-one, in small groups, classes or workshops at North Division High School, 1011W. Center, Rm 158, 267-5171 and South Division High School, 1515 W. Lapham, Rm 111, 902-8509

THRIVE Career Pathways Internship at Journey House

Journey House program seeks motivated adults ages 18 and up to participate in certified trainings in career pathways such as construction, manufacturing, healthcare (non-medical), retail, and hospitality. Nine weeks of FREE intensive training and coaching assists interns to become THRIVING employees to earn family-sustainable incomes (potential earnings \$20,000 to \$37,000). THRIVE program includes 1) Mental toughness; 2) Workforce readiness; 3) Career Day employer tours; 4) Field-work experience; and 5) Employment placement assistance to successful candidates. To participate, select and attend one informational session (9-10am Mar. 15, 20, or 22). Must be available 9-2pm M-F for training. 2110 W. Scott. 647-0548

Want a GED? New skills can mean a better job

Beware of scams: GED tests are never offered online; they can only be taken in person at official testing centers, such as these:

SDC: HSED (PI 5.09/Competency-Based Diploma) & GED classes have a rolling admission process with classes held throughout the year. A TABE score of 5.0 is required for HSED. Apply online at cr-sdc.org by visiting the Programs/Education Services section. Classes at SDC office: 1730 W. North Ave. 906-2750.

Adult Learning Center, 1916 N. 4. Classes for students of all learning levels, from 3rd grade reading level thru high school. Call 263-5874 to sign up for a test for new students. Test fee: \$1

Free Adult Education Classes are offered 9-11:30am Monday-Thursday Dominican Center for Women, 2470 W Locust. 444-9930

The Next Door GED Fast Track and Skill-Building Adult Education Program has orientations for new students every Thurs. Adult education/GED 9-noon Mon-Wed or 1-4pm Mon-Wed. Individualized instruction, transition services to higher education. 2545 N 29. Call 562-2929 x2517

Job help

Journey House at 2110 W. Scott: help with job searches, resume writing, interview prep, open lab Tues/Th noon-2 pm; 1-on-1 appts. financial coaching: credit review, debt, budget. 647-0548

Professional Development at COA, 2320 W. Burleigh: Job leads, resume building, cover letters, help with community needs Fridays by appointment. 265-7689

Goodwill Workforce Center: Free services to help you find a job. No appt. needed. 9-5pm M-F. Job postings, workshops & help with resumes/cover letters, access to computers, Internet, printer, fax; drivers's license recovery program. 3903 N. Richards, 962-4148; 6055 N. 91, 847-4960; 153 W. Oklahoma, 847-4740; 5400 S. 60, 847-1500.

YWCA Career Opportunity Center: resume & job search help, interview practice, on-the-job training. Walk-in, need to fill out intake form. 8am-7pm Mon. & Wed.; 8am-5pm Tues., Thurs. Fri.; 9am-1pm Sat. 1915 N. Dr. Martin Luther King Jr. Dr. 374-1800.

Employment & Life-skills - The Women's Center 505 N. East Ave. Waukesha. Open to the community. Call for topics for free monthly workshops. Additional 1:1 help with resumes, cover letters, interviewing. Free computer use for job search by appointment. Free childcare by appointment: 262-547-4600

Amani Youth in Action is recruiting ages 8-18 for summer clean-ups. 10am-noon 6 Saturdays, July 7-Aug. 11. Lunch will be provided. Clean up Amani one block at a time, learn gardening skills and engage in team building activities. Parents welcome to participate. Also, youth can enjoy field trips and outings during the year.

Get paid to earn a diploma, learn the construction trade YouthBuild provides job training and educational opportunities for youth. Complete the GED or HSED program at no cost. Must be age 18-24, a Milwaukee Co. resident Must register for 1 mandatory info session that's held 1-3pm. Sign up for one single day during the week of May 7-11; course starts May 14.. Info: cr-sdc.org 906-2711

Literacy Services of Wisconsin offers one-on-one and small group tutoring for adults seeking tutoring in math & reading, English language learning, GED/HSED preparation, basic computer skills, and citizenship at 5566 N. 69 (463-7389), 1501 S. Layton Blvd. (643-5108), and downtown at 555 N. Plankinton (344-5878)

Journey House Family Learning Center: Adult Basic Skills, GED in Spanish, & English Language Learning (ELL) classes start in June. English GED starts July 5. Free onsite childcare for morn/eve classes for ages 1-6. Call 647-0548 for info on orientations & to register.

New Concept Self-Development Center: adult education/GED prep. free 9am-noon Tues/Wed/Thurs. Individualized instruction, transition to higher education at MATC. May receive scholarship for \$135 exam fee if comply with requirements and attend class regularly. Visit class to register. 1531 W. Vliet. 344-5788.

Waukesha WCTC campus provides free programs: Adult High School (credit recovery), High School Equivalency Diploma (HSED) & GED, English as a Second Language classes, and more. Programs are available to everyone. To get started, call 262-695-6500 for info.

Free clothing at Southside Mothers Trading Post

If you need infant or children's clothing, visit our Mother's Trading Post, Ascension Lutheran Church, 1300 S. Layton Blvd.

- Used clothing. Now has a limited supply of older children's sizes. You may bring clothing your children have outgrown.
- Each mother may take 1 bag of clothes once every 2 mos., and wipes and disposable diapers for each child in diapers.

The used clothing is free, but mothers are asked to bring 1 or 2 cans of food for the local food pantry (if getting diapers, it's a requirement). Co-sponsors: HOPE Network & Ascension Lutheran Church

When: 9:30-11:30am (MUST arrive by 11:15)
1st & 3rd Thurs: Apr. 5 & 19; May 3 & 17; June 7 & 21

Ascension Lutheran Church

1300 S. Layton Blvd.
(S. 27th St.),

On east side of Layton, one block south of Scott St. Bus # 27

Located in south wing of church; enter southernmost entrance marked by a brown canopy and number "1300." Room is now upstairs; take elevator.

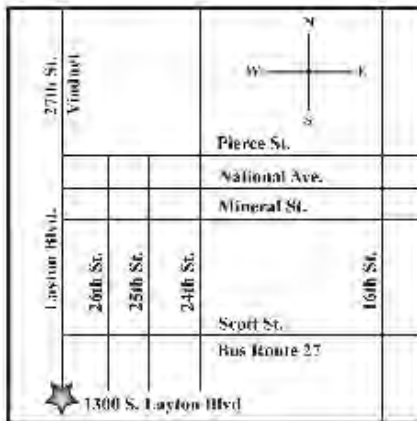

Wis. Women's Business Initiative classes

To register or view other classes: wwbic.com To register for on-line classes, call 263-5450 or email cassandra.plaster@wwbic.com

Permits, Licenses & Legal Structure needed to open your business in the City of Milw. \$10. Mar. 20 6-8pm Center Street Library.

Tech Hacks: Explore apps, software to streamline your business communication and social media presence. \$10 Apr. 4 6-8pm, Women's Financial Wellness Center, N28W23000 Roundy Dr, Pewaukee

Coffee & Cashflow \$15 April 7, 9-11am, WWBIC office.

Avoid Predatory Lending (online course): learn smart borrowing practices, your rights as a borrower, and how to avoid being a victim of predatory lending. Apr. 12 noon-1pm. Free. See above to register.

QuickBooks Level 1: \$50 April 14, 6-8pm WWBIC, office.

Earn Zoo coupon at Great American Cleanup

9am-noon Apr. 21 at Hawthorn Glen, 1130 N. 60. Each year, this cleanup attracts over 100 enthusiastic volunteers to help us put litter and nature back in place. All participants will receive a coupon good for one free admission to the Zoo or one free admission to a Milw. Co. Parks swimming pool/water slide attraction. Help clean for as long as you like (but at least one hour). 647-6050.

Keep Greater Milwaukee Beautiful has announced that the Community Kick-Off Day for the 3-month cleanup campaign will be held at Jackson Park this year. 9am-noon, April 21, with 8:30am registration. 3500 W. Forest Home Ave.

See other cleanup sites & dates at www.kgmb.org



His first book

Cher-Rhonda usually contacts this news magazine to promote health services at her church, but this time she had a surprise announcement -- her young son had written a book! At age seven, Isaiah Thompson published his first book on December 14. *I Keep Getting*

Mad is about a 1st grader's struggle with understanding and coping with anger. He's now a 2nd grade student at Milwaukee College Preparatory School. The book is for sale on amazon.com for \$10.

Rummage Sale at Greendale High School is now a 2-day sale. 7:30-3pm Sat. Apr. 28; half-price sale 10am-2pm Sun. Apr. 29. Spring/summer infant & kids' clothes, toys, play equipment, books, high chairs, strollers, car seats, furniture. No strollers; for safety, kids not allowed at sale until after 10am. 6801 Southway, 2 blocks west of Loomis. www.greendaleentertainment.com

Need a coat? Coats are available from the Salvation Army until Mar. 31 (or until the supply runs out.) Call 464-2940 and tell the receptionist when you'd be coming to pick out a coat (between 8:30am-3pm Mon-Fri.) Coat distribution at 5880 N. 60 St

Huge, multi-day sale of children's items at State Fair Park April 15-21



Spring sale: 700+ consignors selling a huge selection of kid's clothes, toys, strollers, car seats, books, maternity clothing. Wis. Expo Center, State Fair Park. First day, April 15, is \$3, but free with coupon at www.milwaukeecounty.jbfsale.com/ \$6 parking. Or, park on the street or at Gate 6 for free and walk over to the Expo Center. Sun. 8am-7pm; Mon-Wed 10-7pm; Thurs. 10-5pm 25% off*; Fri. 10-7pm 50% off*; Sat. 8-3pm 50% off* *Items without a star are discounted.

First-time parents & grandparents and foster parents may register to shop the presale early on Apr 14. Sign up via eventbrite.com

\$1,000 scholarship available from the General Federation of Women's Clubs of Wis. Lakeshore District. Applicants must be starting their sophomore, junior, or senior year in Sept. 2018.

Applicants must: send proof of GPA of 2.5 or better; be Milw. or Ozaukee County resident; send 2 two letters of recommendation and a personal statement; be full time students in the fields of art, education, international, or health.

The application should include your name, address, county, name and address of college attending, student ID, your year of expected graduation, and the degree you are pursuing (field of study). Applications should be emailed by March 31 to: fcook1350@yahoo.com

Sources for free or low-cost clothing

Reformation Lutheran Church **Neighborhood Store** 3806 W. Lisbon, high quality/low-cost clothes, household, 10am-2pm Tues. & Wed ; 1-4pm & Sat 444-0440

Atonement Lutheran Church, 4521 N. 42, clothes for children, youth, women, & men, 9am-noon Sat. (or appointments: 431-2086)

United Methodist Children's Services 3910 W. Lisbon, noon-4pm Wed. Children's & adult clothing. Photo ID for adults (report card, etc for kids); proof of address. Serves all Milw. County. 344-1818

JLH Women's Mentoring Services, 3846 W. Wisconsin Ave, Ste. 109. For single mothers ages 18+. Limited infant clothing, emergency diapers available. Need Wis. ID & ID or med cards for babies needing diapers. 11am-2pm 2nd & 4th Sat by appointment. 934-0216

Father Gene's HELP Center, 5919 W National. For clothes (all sizes) call 10:30am-noon M, W, or F 258-4357. May use every 6 mos.

Casa Maria, 344-5745, 1131 N 21 St. garage in back. No appt. needed for adult clothes, 11am-2pm Mon. & Wed. For infant clothing, must call first.

Bethany-Calvary Clothes Closet, 7265 W. Center (use east side door). Free clothes for your family (good condition). Open 10am-noon Wed. in June & Aug. Closed July, except on July 22: clothes available during our Share Fair 11am-3pm. 258-2868

House of Peace Clothing Bank 1702 W. Walnut. Bring photo ID, bags. Need appointment. 1-4pm Mon-Fri. 933-1300

Northcott Neighborhood House, adult & children's clothing 10am-2pm M-F. 2460 N. 6 St., 372-3770

Children's Clothing Bank, newborn to size 12; diapers, wipes, toys: 10-noon Tues & Th or by appt. 762-0552 Family Life Center, St Stephen 1441 W Oakwood Rd Oak Creek. Serves all Milw. zip codes

Scott Christian Youth Center, 263-3177, 2741 N Teutonia. Clothing/limited supply/unsorted. Mon.-Fri. Call for hours.

Adullam Outreach, 3025 N. 30. Free clothing, shoes, household items, mattresses, furniture. By appointment only: 216-3025.

Good Samaritan Outreach 5924 W Burnham & other locations, 10-2pm T, W, Th. Need photo ID, proof of current address (dated piece of mail), & ID or med cards for kids. Food & clothes pantry. Call 211 for info re: your area.

Bargain Center North, 8401 W Lisbon, 9:30-3:30pm Tues.- Sat

463-2595; **Bargain Center South** 5005 W Howard, 9:30-3:30pm Tues-Sat 327-2529. Both have clothing, household goods; cash only. South location also has furniture.

Pregnancy Help Center: 1225 W Mitchell, Ste 217, free maternity & baby clothes up to size 4T, free diapers to size 5, free formula (as available), layettes, Mon-Fri 9-4. Call if not used before. 645-4050

Milwaukee Birthright 2025 W. Oklahoma Ste. 125, newborn clothing, blankets; must call 2-3 wks (for appt.) before due date. For layettes, need photo ID, pregnancy statement or birth announcement. Mon 12:30-6pm; Tues & Th noon-4pm; Wed. 10am-2pm 672-5433

Blessed Again Resale, 7624 W. Hampton, 10am-4pm Mon-Sat, low-cost children's, maternity, adult clothing, shoes, furniture, elec-

tronics, housewares, etc. 464-9099

Well-Rounded Maternity Center 2455 S. Howell Ave, Bay View Maternity clothing resale. 11-7pm Tues/11am-5pm W-Sat 744-7001

Economy Center 7814 W Burleigh 9:30-4pm T-F; 'til 3 Sat. Clothes, household, books, toys, some small furniture for sale. 442-2272

Resale Shop run by Christ Child Society, located on Our Lady of Good Hope Church campus, 40th & Good Hope. Clothes for women, men, and children. Use front parking lot. 9:30-3:30pm Tues/Thurs., 9:30-12:30pm 1st & 3rd Sat. 540-0489

Red Door Clothes, St. James Episcopal Church, 833 W. Wisconsin. 1st & 3rd Sat, 8:30-10:30am. 271-1340

Wellington Park Lutheran Church 10-11:30am 1st Sat. of mo, 7017 W Medford (1 blk. north of Hampton), free clothing; \$1 donation or bring 1 non-perishable food item. 461-4061.

RePurpose, 8211 W. Brown Deer Rd., is stocked with donations that have been repurposed for sale: household furnishings, office furniture, clothing, gift items. T-F noon-7pm and Sat 10am-5pm, 977-4250 Proceeds help fund the nonprofit's initiatives to train at-risk youth for the workforce. St. Charles Youth/ Family Services program

St Vincent Thrift Store 9am-9pm M-S 2320 W Lincoln 672-2040

St. Vincent de Paul Society: May have help for you if you live in area of a donating parish w/funding. In Milw call 462-7837; Waukesha: 262-547-3281; Ozaukee Co: 262-284-4637

Interview attire for women/men in need: DIVA/DIVO in Bay View & northside: Must have referral from case worker, job trainer, etc. e-mailed on letterhead with a signature to michele@diva-divo.org. See criteria at www.diva-divo.org

Bottomless Closet: interview clothes for men & women & help with communication/interviewing skills. M-F by appt. only. 270-2984



Greenhouse Annex at

The Domes, 524 S Layton Blvd. 9am-1pm Sat. Fresh local vegetables, meat, eggs, baked goods, jams, sauces, soup, prepared hot food by about 50 vendors. Run by Fondy Food Center. Free parking, free admission to the market (but not the Domes).

Buy \$40 worth of food for \$20 on Quest card

Double your dollars! The Milwaukee Winter Farmers Market at The Domes will match the amount you take off of your Quest card at the market, up to \$20 each Sat. That means if you take \$20 off of your Quest card, you'll get an additional \$20, for a total of \$40. You can use to purchase SNAP-eligible items (limited to fruit and vegetables). Thru Mar. 31, or until the funds run out

Used furniture dependent on availability. Must pick up from Faith Builders, 4901 S. Howell, Info: mrhaley@gmail.com

Spring Marketplace 9-3pm Apr 14, Meno. Falls H.S.. Vendors, crafts, jewelry, demos, raffles, rummage. \$1. For space for a vendor or rummage, contact 581-0352 or cleague@communityleague.com

Emergency Food Pantries

It's best to call 2-1-1 to find a food pantry in your area. They will know which have adequate supplies that day to help you, and which have baby formula in stock. Also see p. 3.

53202, 53203, 53211

Interchange Food Pantry, 130 E Juneau (1 block west of Water) 2-5 pm Tues; 4-7pm Wed; 9-11am Thurs. 276-4108.

53206, 53209, 53210, 53212, 53216, 53218, 53222, 53223, 53224, 53225

Trinity Presbyterian, 3302 N Sherman Open Tues, 9-10:30 am (or until nos. are gone); visit 2X per mo. 871-9440

53205, 53206, 53208, 53210, 53212, 53213, 53233

Divine Word Lutheran Church, 5505 W Lloyd. Open Thurs, 9-10:30am (or until nos. are gone); visit 2X per mo. 476-3189

53205, 53208, 53233

Central City Churches Outreach Ministry, Our Savior's Lutheran Church 3022 W Wisconsin. 9:30-11:30 M-Th. Photo ID w/address for area residents. Also, baby formula. 342-1522

53205, 53206, 53233

House of Peace, 1702 W Walnut, M-F 8:30-noon 1-3:30pm; can use 1X every 30 days; bring photo ID, proof of residence, ID for each household member. Free legal clinic 3-7pm Tues. Clothes 1-4pm with photo ID. BY APPOINTMENT ONLY. 933-1300

53206

Emmaus Lutheran Church, 2818 N 23, 9:30-10:30am Wed 1st come/1st served; need photo ID, proofs of address & kid's ages (e.g. report card or Medicaid card) 444-6090.

53206, 53210, 53216

Jewish Community Pantry: address on building is 2930 W. Center St., but pantry is at 2900 W. Center St. which is on 29th St. – northwest corner. 9am-3pm Thurs. (must arrive by 2:30 pm); 10am-2pm 3rd & 4th Sun. of the month (must arrive by 1:30 pm). ID and proof of address (current mail) required. Infant formula: need proof of child's birth date. ID for all household members required by 2nd visit. Call 447-8901 (answered only when pantry is open).

53209, 53218, 53225

Silver Spring Neighborhood Center, 5460 N 64, noon-2pm Mon; 11am-2pm Tues; 10-noon Thurs. Stock box distribution for 6 mos & 1 yr; 5-yr-old WIC grads; seniors: 1-3pm F 463-7950

53212

Northcott Neighborhood House 10am-2pm M-F Bring proof of residence, photo ID for you, other ID for household members 372-3770

53218

Peace Lutheran Church 5229 N 51. 2:30-4:30 Wed; 10-noon Sat plus emergency needs; community meal 11-1pm & 5-6p Wed. 461-2763

53222, 53225

Northwest Baptist Church 4373 N 92. 4-7pm Wed. Need photo ID, piece of mail for adults, kids' report cards etc. Has infant formula for zip codes 53222 and 53225. 463-3630

53224 Zion Rock Food Pantry, 5-7pm Tues; 10am-noon Sat. IDs for all in household and proof of address. 10230 W. Fond du Lac

Scott Christian Youth Center: 2741 N Teutonia noon-2pm 2nd & 4th Tues. Clothing bank. Hot meals: 10-11am M-F; 3:30-4:30pm M-Th For pantry, need photo ID; age verification for kids 263-3177

United Methodist Children's Services 3910 W Lisbon, noon-4pm M, W. Photo ID adults (report card, etc for kids); proof of address for adults & kids; serves 53208, south portion of 53210. 344-1818

Christ Lutheran Church 2235 W Greenfield, 10am-noon (lines form at 9am; may close early if supply is gone) 2nd Sat of mo., food pantry, free clothes. Bring ID. 645-5138

53204

HOPE House, 209 W Orchard, 12:30-2:30pm Tues. & Thurs. 10am-noon Sat., bring ID & proof of residency. 645-2122.

53204 (south of Greenfield Ave.), 53215

St. Hyacinth/St. Anthony food pantry, 1414 W. Becher, 12:30-2:30pm Tues; 4-6pm Wed; need ID of everyone in household & proof of address. 383-4010

St. Peter Lutheran Church, 1204 S. 8 (Scott), 3rd Sat. 10am

53215

Milw Christian Center, 807 S. 14 St. 1-3pm M-Th, 10-noon Fri. Must be in zip code 53215 or live within service area between 13th & 43rd Sts, from Pierce to College. Need ID of all in household & proof of address. 645-5350 ext. 118

South side: live in area south of Wisconsin Ave., north of Ryan Rd between 27th & 124th Sts. Good Samaritan Outreach Center 5924 W Burnham, 10-2pm T, W, Th. Need address proof (current piece of mail), photo ID for everyone in household. 541-7668.

South side: 53207, 53221, 53235, & part of 53215 south of Becher, east of 27 St. Bay View Community Center, 1320 E Oklahoma 4-6pm Tues; 2:30-5:15pm Wed; 2:30-5:15pm Fri. Photo ID, address proof/current piece of mail, proof of income. Adults need SS cards. Kids: SS, report cards, or birth certificates. 482-1000

Oak Creek Family Life Center 1441 W. Oakwood Rd 53110, 53129, 53130, 53132, 53154, 53220, 53228, 53235 for adults, children. For formula, need WIC folder. Bring proof of address, photo ID. 10am-noon Tues. & Thurs. or call for appt. 762-0552



Milwaukee Habitat's newest resale store and donation center opened at 4150 S. 108th St. in Greenfield. (Site of former Bartz's Party Store on Hwy. 100.) Shoppers can find gently used home furnishings including sofas, chairs, tables, cabinets, bookshelves, and sometimes stoves and refrigerators at a fraction of their retail price. You can also find home improvement supplies and building materials such as doors, windows, lighting, and flooring. Run by Habitat for Humanity. **ReStore West:** 3015 N. 114, Wauwatosa, 316-5650; this is the only store open Mondays. **ReStore East:** 420 S. 1, 316-5682. **ReStore South:** 4150 S. 108th St., 257-9078

ReStore Waukesha: 2120 E. Moreland Blvd. 262-662-6061.

Single Mother Want Ads

Single mothers may place an ad here or in bi-monthly Updates for \$1. Free to HOPE members. Send ad to info@hopenetworkinc.org. **NOTE:** HOPE Network does not do background checks on childcare providers or clients.

PROVIDING CHILDCARE

Need a babysitter? I am very good with children and will give 100% of my attention to your kids. I am trustworthy, reliable, loyal, responsible, and a great, loving person. I can do simple homework. I am looking forward to working with you. Megan, 628-6812.

A Joyful Noise Childcare is currently enrolling. Our center focuses on the social/emotional, cognitive, language & physical development needed in order to be successful in life. Stop in, follow us or call to schedule a tour! 9700 W. Appleton Ave. Call Mrs. Rachel: 393-9786 M-F 5am-midnight & weekends 6am-8pm Transportation is offered (inquire about details). www.Facebook.com/Ajoyfulnoisearchildcare

Little Miracles Family Daycare: 10 weeks-12 years. Weekends only; 1st & 2nd shifts. Private pay only. Nutritious meals; clean, safe environment; free transportation. 519-2345.

Granny's Babies Day Care, ages 6 wks-13 yrs. Open every day 6am-10pm. Accepts W-2 & private pay. Safe home-like setting. Milw. north-west side. Call 263-7230 for tour and interview.

Explorers of Truth Child Development is accepting enrollment for 2 wks-8 yrs of age. 6am-6pm Mon-Fri. Accepts Wis. Shares and private pay. Warm, home-away-from home family setting. Safe and clean environment, healthy meals and snacks, weekly lesson plans. North side of Milwaukee Contact Ms. Kee-Kee 455-3156.

Safe-N-His Arms home-based childcare services: Where we care for the little people. Nutritious meals, snacks, educational training, field trips. Safe, clean, loving environment. 2nd & 3rd shifts available. 2-11pm M-F. Call Cheryl Johnson: 336-5930

Safe-N-His Arms Support Services. Prenatal & childcare coordination, infant massage, & screening for high blood pressure, glucose, or breast health. 2821 N. 4, Ste. 207. Cheryl 336-5930

Rose's Tiny Town Family Childcare: licensed, CDA & administrative credentials, Young Star rating: 3 stars. Educational environment, nutritious meals, nurturing provider (20+yrs. experience). 6am-10pm M-F, 6 wks-12 yrs. W-2 or private pay. Call Ms. Rose at 466-6914.

Destiny's Child Christian Academy Daycare, educational activities, quality childcare. Enrolling all ages. Group center with homelike one-on-one attention. 535-1733

FOR SALE

Twin bed frame, \$15; small, padded **bench,** \$10; bed headboard on legs with organizer compartments, \$15; blue, blow-up **chair** \$5; and a couple hundred **plastic hangers,** different colors, \$15. Call Pam 774-0945

SERVICES & NETWORKING

Lashes by Imani: Eyelash Extensions. \$65 Classic Full Sets \$35 Fills. Call/Text Imani for appt. & info: 803-6704 IG: @lashes_by_imani email: lashesbyimani@gmail.com (Mention ad for 10% discount!)

Sunny View Cleaners: Hate cleaning? Want more time to spend with your family? Let us get the job done for you! Receive 20% off all cleaning services on your 1st job. Call/text Whitney 262-720-6864 or view www.sunnyviewcleanerswi.webs.com/

A Dash of Art: Customized Art by Whitney. Are you looking for that special gift for someone that they'll never forget? Then what better way to do so than to get some customized artwork done. Call/text Whitney at 262-720-6864 or view www.dash-of-art-by-whitney.webs.com/

Looking for any stay-at-home-moms that would be interested in a work-at-home business opportunity, that not only allows you to spend more time with your family, but also to get back to your optimum health. Email Whitney whitneyomadison@yahoo.com call/text 262-720-6864

Clean your home - That is me! I do a walk-through before doing the work on your home. Each room is \$50 and the kitchen is more. Looking forward to hearing from you soon. Megan, 628-6812.

For Hire: Why waste your life cleaning? When I can do it! Make your chores my responsibility! All quotes/rates negotiable. From kitchens to closets or errands to laundry, give me a call. Michele 554-2395

Help wanted for the Growing Tree Childcare Center, a program of United Methodist Children's Services. Full-time early childhood lead and assistant teachers for 1st and 2nd shifts. Send resume to theresa.purifoy@umcs-wi.org or call 344-1818

Become a **Child Care Teacher:** 8-week training program FREE to those who qualify! www.networxllc.net 362-4209

Do you need CPR, AED or First Aid training? Would you like training in your facility? No class too big or too small, we teach them all. Continuing education, completion card & certificate at the end of training. Classes in a.m., p.m., 7 days a week. No need to take time off of work, we can come to your facility during nap time, lunch time, etc. We offer a DISCOUNT on certification classes for 10 or more participants.

FREE non-certified CPR/First Aid classes for mothers, grandmothers, or anyone who doesn't need certification but would love to learn the skills to keep their family safe.

Other training offered: SIDS (sudden infant death syndrome), Shaken Baby Syndrome, blood borne pathogens, CPR Pro, Medication Administration. Call Heart_2_Heart Basic medical training today at: 933-2323.

Face Painting Art Designs by Ms. Gabrielle Howard-Brown for birthday parties \$60 (larger events may cost more), reunions, church events, holidays. Water-soluble, non-toxic paint. For special circumstances price is negotiable. Text to 921-8609 or email gabrielleandson1@yahoo.com

Aisha Event Planning offers services for graduations, family events, birthdays, etc. Reasonable prices. Call Aisha, 519-2345.

Character Parties: Are you planning a party for your child and want to add that special touch? Call *Let's Party* and invite one of our characters to party with your child & guests! Teenage Mutant Ninja Turtles, Frozen, Mickey & Minnie, & more. Call today for booking and prices 366-1118

Tammy does **hair weaves** (sew-ins) for \$30. 988-4467.

Party Coordinator I'll make your party fun with games and prizes to keep your guests entertained. Call me for birthday parties, baby showers, bachelorette parties, etc. \$60 per hr./ \$40 for 30 mins. Renee 899-0973

Marlita Media Photography for every stage of life, inc. maternity, newborns, families, weddings, birthdays, reunions, graduations. I love producing beautiful pieces of art for my clients that preserve their precious memories. Affordable; flexible schedule. Marlita 394-5565

Make a statement with **Mari's Statement Collective!** Affordable statement jewelry pieces, scarves, handbags & more. Contact Shawn Marie at 465-8675. M.statement.collective@gmail.com

***** Part-time jobs in housekeeping** available at Home2 Suites in Menomonee Falls. 8am to about 2pm, 2-5 days a week. Call 262-737-7100, or stop in at the hotel, N91 W15851 Falls Parkway.

Summer camps: most offer financial aid, scholarships

All Hands Boatworks: RiverVentures 1-Week Camps: June 11-15, 25-29, & Aug 6-10. FREE to students living in Milwaukee, ages 12-17. Boat building, rowing, sailing. no swimming required. Learn about careers in carpentry, water tech, and environmental science. July programs also. www.allhandsboatworks.org 949-9142.

Summer Camp at Urban Ecology Center

Enjoy healthy outdoor fun with kids from all over the city. Explore the secrets of nature by looking under logs, hiking in the woods, climbing trees, building forts, creating art projects, taking pictures...

Preschool thru high school week-long day camps. Camps are held at UEC branches: Riverside Park, Washington Park, and Menomonee Valley. Almost half of their 880 spots are reserved for families in need of scholarships. Apply at: urbanecologycenter.org Info: Kirstin Anglea, 964-8505, x125.

According to one of our HOPE Network members who enrolls her daughter every year: "I REALLY encourage children to do this [go to the Urban Ecology camps]. UEC has a painless scholarship application process, and once you're accepted in a camp, you also get a yearly family membership for free."

Teens Grow Greens: Elementary school students learn how to be successful growing food, character and community under the guidance of a teenage mentor in this summer program. Students meet every Wed & Fri in the Franklin Heights and Amani neighborhood. Please email teensgrowgreens@gmail.com to sign up.

Art, Dance, Music

Casa Romero: Art Club and MC in ME summer camps offer experiences for girls ages 10-14 to create art and music projects to express their message for their community. M-F 9am-4 pm; June 25-29, July 9-13, July 30-Aug 10; financial aid available;. Contact Valencia or Annie at 224-7564 or info@casaromero.org

Danceworks: Summer Creative Arts Camps integrate dance and visual art along with music, creative drama and creative writing into one program; Designed for ages 3-17, programming is inclusive of all abilities and learning styles. Need-based scholarships available. Visit danceworksmke.org or call 414-277-8480 for more details.

Wild Space Dance Company: Get wild with your creativity at Wild Arts Camp at Lincoln Middle School; Participants (ages 10-14) create dances, artwork and theater scenes to share in a final show. Runs 9-12noon; Mon-Thurs, June/ July 2018; Wild Arts is free to Milwaukee Public School students; Contact 414-271-0307; info@wildspacedance.org; or visit wildspacedance.org.

Milwaukee Youth Symphony Orchestra: MYSO offers students ages 10-18 a FREE two-week Calypso Steel Pan Band camp in June/July. Limited spots are available. Steel pan experience not required. Note reading skills are helpful, but not required. Contact Kate Goerdt at 267-2949 or kategoerdt@myso.org.

First Stage Theater Academy year-round classes foster life skills through stage skills, such as acting, musical theater, improvisation and more for all students, including those on the autism spectrum. Financial assistance available. www.FirstStage.org

Milw. Art Museum See p. 12 for camp (scholarship available)

Concordia's STEAM Camp (Science, Technology, Engineering, Arts, Math): a hands-on, high interest exploratory camp for Grades 3-8. 9am-noon OR 1-4pm. July 9 - 13. Concordia University, 12800 N. Lake Shore Dr., Mequon. Cost: \$99 ea. half-day session **Scholarships available** for children eligible for free/reduced lunch thru WI DPI: Wis. Educational Opportunities Program, 227-4466; or contact Dr Kremer Concordia 262-243-4271 www.cuw.edu/steam

King Community Center Summer Camp June 18-Aug. 3 9am-4pm M-F. Ages 5-12. Field trips, cooking, karate, gardening, sport camps. Includes meals, one-yr. membership to the Center's after school program. 1531 W. Vliet 344-5600. Call for application and summer camp price. We will also be running a youth basketball league. Please contact center for dates and times.



Walker's Point Center for the Arts

Eight-week camp begins June 19. During school year, free after-school art classes. See p. 12 for more info or visit wpcamilwaukee.org.

Summer Recreation Enrichment Camps thru MPS Milwaukee Recreation. Each week has a different theme involving sports, games, arts & crafts, fine arts, outdoor education, math & reading enrichment, clubs, and field trips. 7am-6pm Mon-Fri, June 18-Aug. 10. Ages 3-12. Visit MilwaukeeRecreation.net for locations, camp fees, and other details or call 475-8701

Peacemakers Day Camp: 8:30am-1:30pm July 16-20 or July 23-27 (choose one week) Quaker Friends Meetinghouse, 3224 N. Gordon Place in Riverwest. For ages 6-12. Focuses on gentle, non-violent conflict resolution, team building, feeling talk/communication skills for children. Nonreligious. Children bring their own lunch. Recommended by a HOPE Network mother. Info: Janet, 324-1650, or George 313-9579. Cost for the week: sliding scale of \$20-50. www.peacemakerscamp.org

Journey House/Kagel Summer Camp, 1210 W. Mineral ages 5-14. \$40 per child 9am-4pm M-F June 18-July 27. Before and after care available for additional cost: 7am-9am and/or 4-6pm

Journey House/Longfellow Summer Camp, 2110 W. Scott; ages 5-14 \$50 per child 9am-4pm M-F June 18-Aug 10 Before and after care available for additional cost: 7am-9am and/or 4-6pm After April 1, can call 647-0548 or email info@journeyhouse.org

Y Day Camp: at 5 sites for ages 4-12. Scholarships are available and Wis. Shares state and county funding accepted; call 276-9622 for info. Camp dates Jun 11-Aug 24. Each camp offers traditional, sports, and specialty camps, and Northwest YMCA also has an adaptive camp. Camps offer free before- and after-care, weekly field trips, free breakfast and lunch, and discounted swim lessons option at Rite-Hite. Bus transportation from a pick-up site for each camp is available. Camp sites: Northwest YMCA, 9050 N. Swan Rd. Parklawn YMCA, 4340 N 46th St. Rite-Hite Family YMCA, 9250 N. Green Bay Rd., Brown Deer YMCA at Greene Park, 4235 S. Lipton Ave., St. Francis.

Heartfelt thanks to our volunteers, donors

We're grateful to our many donors from Nov. 15-Feb. 28. We value all contributions, whether money or goods, time or talent.

Ronald & Kay Antoine
Ascension Lutheran Church
Thomas & Donna Bakke
Pauline Beck
Kristin Beison
Jean Berenschot
James Bickler
Kathy Bitante
Blessed Savior Church
Kevin Bourassa
Bradford Memorial AME Church
Don & Lynn Broesch
Nancy Budish
Holly Buechner
Lynn Buszkiewicz
Trish Cady & friends of Rachel Sciortino
Cedarburg High School
National Honor Society
Christ Child Society of Milwaukee
Amy Clark
James & Beverly Cline
Dr. E.A. & Pat DeGuzman
Tom & Carol Deming
Jill Demski
Jean Dickman
Thomas & Elizabeth Diedrich
Therese Dineen
Ken & Bonnie Dison
William Dosemagen
Donald Dugen
John & Margot Dunn
Paul Duquesnoy
Susan Eggleston
Emmanuel Community United
Methodist Church
Terri Enghofer
Eaton Corp. Charitable Fund
James & Sherron Felton
Festival City Symphony
Edward & Claire Fink
Arlene Foti
George & Patricia Frommell
Gail Gardner
Sarah Gardner
Emily Gierlich
Donna Glass
Gloria Dei Church
Randy & Beth Gonstead
Good Shepherd Catholic Church,
Meno. Falls
Robert & Nancy Gorzek
Lois Graff
Walter & Cathy Grannen
Mary Grenier
Rev. Ralph Gross
Nadiyah Groves
Shelly Hansen

Deanne Haugen
Crystal Hearvey
Karen Hebert
Lois Heider
Laura Hensel
Shirley Hicks
Claude & Georgia Hoerig
Darryl & Dorothy Hoffmann
Home2 Suites Employees & Guests
Sue Ishihara
Katie Kershek
Steven Kessler
Brad Klages
Roger & Sandra Klein
Knight of Columbus Holy Hill
Council #7798
Kohl's Associates in Action
Tom & Sue Kress
Mary Kay & John Lammers
James & Sandra Lembke
John & Olive Lietzau
Jeff & Chris Lodl
Judy Lohmann
Craig & Lisa Lopacinski
Alan & Kathleen Luening
Pat Luther
Michael & Mary Ann Lynch
Sureshkimar Marimuthu
Andrew Meyer
Vincent & Elyce Moschella
Derek & Susan Murphy
NewThreads of Hope
Mary Nitzsche
North Shore Cong. Church
Pam Oberg-Sutton
Brianna Ortega
Palmer Family Foundation
Thomas Pelt
Noel & Lynn Petzold
Mary Pionke
Linda Pletta
Charles & Lynn Poat
Leah Pounds
Queen of Apostles Prayer Shawl
Miinistry, Pewaukee
Greg Renz
Blake & Sarah Rigel
Krista LaFave Rosolino
Holly Ryan
St. Bernard Parish
St. Leonard Parish
St. Mathias Parish
St. Pius XI Parish
Jean Schilke
Barb Schmit
Jane Schmitz
Meagan Schneider
Mary Schuldenberg
Marilyn Schultz
Phil Schumacher
Tony Sciortino
Joan Shanley
Jennifer Siewert

Silvernail Sewing Club
Norman & Mary Smaglik
A.J. Star
Mary Steinbrenner
Sharon Steurer
Swallow School Student Council
Charlie & Katie Sweet
Michael & Gail Sweet
Gabriel Tawil
The Church of Jesus Christ of
Latter Day Saints Youth
Ray Thornborough
Mary Ellen Thoss
Trackside Services
Ron & Mary Wallenfang
Joann Walsh
Lisa & Curtis Waltz
Kathy Wambold
Jim & Bev Washcovick
Joshua Wheeler
Harlow & Mary Wilford
Bob & Pat Wille Fund of the
Greater Milwaukee Foundation
Wisconsin Right to Life
Milwaukee Chapter
Marianne Wrocklage
Angela Wilson
James Wilson
Jim & Sue Yenter

In Honor of

Jim Bickler by:
Paul Collins
Dawn Goodno by:
Patricia Maier
Lillian Love by:
Anita Doubek
Sarah Waddell by:
Curtis & Nancy Waddell

In Memory of

Ervin Benish by:
Pat Benish
Mark Clausen by:
A.J. Star
Ted, Audrey & George Grenier by:
Terre Woodward
Ken Herro by:
Gabriel Tawil
Nancy Hibben & Bev Mantyh by:
Paul & Ramona Petry
Carl Komassa by:
Carol Komassa
Charlotte Koester by:
Michael & Gail Sweet
Nancy Reinsvold by:
Greg & Helen Reinsvold

Virginia Gerbyshak Schwister by:
Marilyn Zuehlke

Rachel Sciortino by:
Trish Cady & Friends
Cedarburg High School students
Karen Hebert
Paul Henke
Marie Holley
Amy Jorgensen
Robert & Joan Klein
Kimberly Lemen
Robert & Stacy Leuty
Lisa Lopacinski
Phillip Nensel
Mary Nitzsche
Robert & Patsy Pathey
Maureen Perkins
Christopher & Susan Pitzo
Phil & Karin Ritter
Rodney & Shelby Ross
Kathy Wambold
Anthony & Lisa Wilcox

Bianca Shaw by:
Michael & Krista Rosolino

Katie Simon by:
Pauline Beck

General & Mrs. Nan Kwang Tan by:
Celine Robertson

Edmund & Suzanne Springman by:
Stephen Springman
Gary & Susan Springman

Sandra Weber by:
AJ Star
Phil Schumacher & Pauline Beck
John Weber

Portia Williams by:
Lisa Lopacinski
Gail Sweet

Remember HOPE Network...

Please consider including HOPE Network in your estate planning, or in a directive to your family. Estate bequests, both large and small, play a vital role in supporting HOPE Network in its mission to provide assistance to single mothers in the greater Milwaukee area. Contact HOPE Network today about any questions you have, or to learn more about how gift and estate planning can benefit you and HOPE. Your inquiry is always confidential.

CHANGE SERVICE REQUESTED

Help Wanted

Unpaid volunteer position: We need a silent auction co-chair for our Fall Fundraiser Oct. 5. Present co-chair has years of experience but needs a partner. Hours flexible. This job is loads of fun! You get to go through attractive donated items, create interesting baskets, and finally set up your own “store” (our silent auction) at Davians Oct. 4 and 5. You work with happy people who believe in HOPE’s mission. Work begins in early summer. Call 262-251-7333 if interested.

Paid volunteer position: We need an event coordinator for our Fall Fundraiser Oct. 5. This person works with office staff and volunteers overseeing details of event. Hours flexible. Work begins in early summer and continues during the event Oct. 5 at Davians. Pay is \$12 per hour. Attention to detail a must; past event coordinator experience helpful. Send cover letter and resume to HOPE, PO Box 531, Menomonee Falls 53052 or info@hopenetworkinc.org

We need your help!

Thanks to the Townsend Foundation for their \$2,500 grant for the May awards, and to these donors who are generously funding full scholarships: Greenfield Woman’s Club, Trackside Services, and AJ Star (two grants).

We’d like to award seven scholarships this year of \$1,200 each, but we need your help! Please donate so we can reach our goal, and help these mothers attain a better life for their families through education.

Since 1988, \$100,200 in grants has been awarded to 98 mothers.

--- Here’s my donation to HOPE ---

___ Please put my donation where you need it most!
Or: I’m passionate about: ___ Scholarships ___ News magazine
Check enclosed or Charge \$ _____ donation to credit card:
___ VISA ___ Mastercard ___ Discover (Or use Paypal on our www)
Name as it appears on card _____
Credit card number _____
Expiration _____ 3-digits on back _____
Address, and MUST include Zip code _____
Signature _____

HOPE Network, P.O. Box 531, Menomonee Falls, WI 53052



How can HOPE Network help you?

We are here to help single mothers in Milwaukee, Waukesha, and counties surrounding Milwaukee.

Our programs:

- help give single mothers a sense of community
- help them enhance their parenting skills and develop self-reliance
- aid them in planning a future for themselves and their children.

HOPE Network provides

- * this quarterly resource news magazine
- * safe sleep education and new portable cribs
- * scholarships
- * a clothing bank
- * occasional tickets for family outings

HOPE Network is a volunteer-based grass-roots support system founded in 1982 by local resident Gail Grenier Sweet. It provides emotional, educational, and material support to single pregnant women and single mothers, as well as to other single females who are raising children (grandmothers, aunts, and so on). Call us at 262-251-7333, email info@hopenetworkinc.org or see our contacts below.



Stay in the loop on HOPE Network news, activities & community events!
Twitter: @HOPE_Network



Facebook
www.facebook.com/hopenetworkinc

Website
www.hopenetworkinc.org